

Brighter World Brighter Life

更明亮的世界·更明亮的人生

Optoelectronics Through Hole Lamp



Provide LED Total Solution Since 1981
提供LED全方面的解决方案



佰鴻工業股份有限公司
Bright Led Electronics Corp.



About Bright Led Group

佰鴻工業成立於1981年，是一家具有三十多年生產銷售經驗的LED光電元件專業製造廠商，也是台灣知名的LED股票上市公司。

集團營運總部位在台灣新北市，在香港、韓國首爾、美國加州等國外地區分別成立銷售分公司，同時也在世界各地建立了經銷代理網絡服務全球客戶，為了加強中國大陸市場的拓展，在中國地區成立了許多銷售通路及辦事處，進行LED照明光源及燈具的推廣及客戶服務。

主要生產基地在中國廣東東莞，主力產品包括數碼管、直插發光二極體、貼片發光二極體（SMD）、大功率LED、COB、紅外線產品及LED車燈、路燈、隧道燈、天井燈、投射燈、燈泡、燈管、平板燈、筒燈、號誌燈、全彩看板、植物生長燈等，藉由轉投資的藍寶石廠、LED晶片廠、支架PCB衝壓加工、及塑膠射出...等多家關係企業的垂直整合下，形成LED產業鏈，能提供最佳性價比的產品給客戶。

佰鴻工業擁有光、電、機、熱方面的專業研發團隊，開發LED在照明應用上的先進技術，提供四十多篇國內外專利申請。未來佰鴻工業將續以LED專業製造廠的角色，不斷地提供人類更節能、更環保、更變化的新世代照明。



Bright LED, founded in 1981, is a professional LED optoelectronic manufacturer and a well-known publicly listed LED company in Taiwan market for more than 30 years.

Bright LED group headquarter locates in New Taipei City, Taiwan. We have several sales branches in China, Hong Kong, Japan, Korea, Germany, Singapore, US and other countries as well. Meanwhile, Bright LED also establishes a long term relationship with distributors/dealers around the world to serve global customers with high efficiency and best solution.

In order to strengthen the expansion in China market, we also established offices within several districts of China to promote and sell LED products and to provide customer service.

Our main factory locates in China. Our main products include LED digits display, DIP LED, SMD, high-power LED, invisible, as well as, LED automotive lamps and LED lighting products...etc. The Sapphire subsidiary, wafer factory, PCB assembly factory and other subsidiaries within Bright LED group formed our own upper, middle and lower stream of product supply chains and so contribute much reliable and best C/P products to customers.

Bright LED possesses the outstanding R&D team with their professions in lighting, electronic, electric, and heating areas. We constantly develop advanced technologies in LED field and as a result, we now have more than 40 local and international patents. Bright LED, as a role model of professional LED manufacturer, commits to provide better energy-saving, eco-friendly, and more diversified developments of LED in new era.

BRIEF HISTORY OF BRIGHT LED

- 1981 Company established and started the production of LED Indicator Lamps**
- 1990 Established both Dong Guan factory in China and Distribution Center in Hong Kong**
- 1995 Developed and started SMT LED Production;
Established U.S. SALES OFFICE in L.A. California.**
- 1999 ISO-9001 and QS-9000 certified**
- 2000 New Dong Guan factory started production**
- 2001 Listed at Taiwan OTC**
- 2002 Listed at Taiwan stock exchange market.**
- 2004 ISO 14001 certified RoHS compliance**
- 2005 ISO/TS16949:2002 certified**
- 2013 Established Bright Wonder Science & Technology Park**
- 2014 Established Henan Jinghong Optoelectronics Technology Co., Ltd**
- 2017 IATF16949:2016 certified**



CONTENTS

- 3mm Round Type 5
- 4mm Round Type 14
- 5mm Round Type 14
- Blinking Lamp Type 22
- Resistor Lamp Type 22
- 8mm Round Type 23
- 10mm Round Type 23
- Rectangular 24
- Cylindrical 30
- Tower 31
- Triangular 32
- Ellipse 32
- Holder Assembly 33

3MM ROUND TYPE

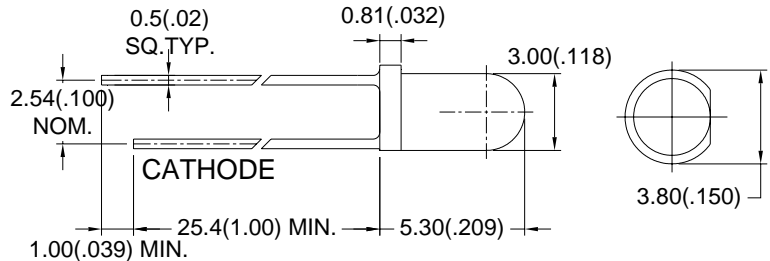

Unit: mm (inch)

Part No.	Emitted Color	λd (nm)	Lens Appearance	Vf(V) @ I _F =20mA		IV(mcd) @ I _F =20mA	Viewing Angle 2θ _{1/2} (deg)
				Typ	Max	Typ	
BL-BB53V1	Blue	460-475	Transparent	3.2	3.6	3000	30
BL-BG83V1	Green	520-535	Transparent	3.2	3.6	5550	30
BL-B2141	Yellow Green	566-576	Color Diffused	2.2	2.6	40	35
BL-B3141	Yellow	580-595	Color Diffused	2.1	2.6	45	35
BL-BJC3V1	Amber	600-612	Transparent	2.0	2.6	2300	30
BL-BJZ3V1	Orange Red	620-630	Transparent	2.0	2.6	6775	30
BL-BUF341	Red	625-637	Transparent	2.1	2.6	800	30
BL-BZ73V1	White	X=0.32, Y=0.31	Transparent	3.2	3.6	3100	30

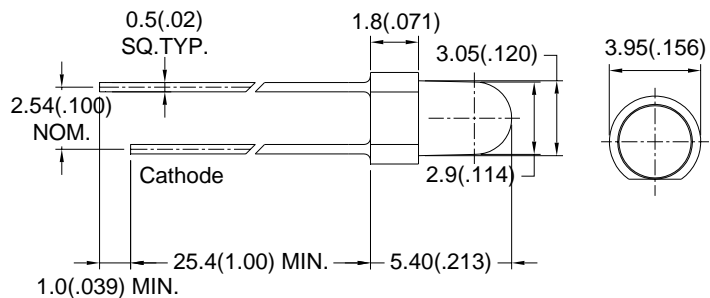

Unit: mm (inch)

Part No.	Emitted Color	λd (nm)	Lens Appearance	Vf(V) @ I _F =20mA		IV(mcd) @ I _F =20mA	Viewing Angle 2θ _{1/2} (deg)
				Typ	Max	Typ	
BL-BB51V1G	Blue	460-475	Color Diffused	3.2	3.6	260	35
BL-B2141G	Yellow Green	566-576	Color Diffused	2.2	2.6	40	35
BL-B3141G	Yellow	580-595	Color Diffused	2.1	2.6	35	35
BL-BJE3V1G	Orange Red	615-628	Transparent	2.0	2.6	3500	30
BL-BUF4V1G	Red	625-637	Color Transparent	2.1	2.6	1800	30

3MM ROUND TYPE

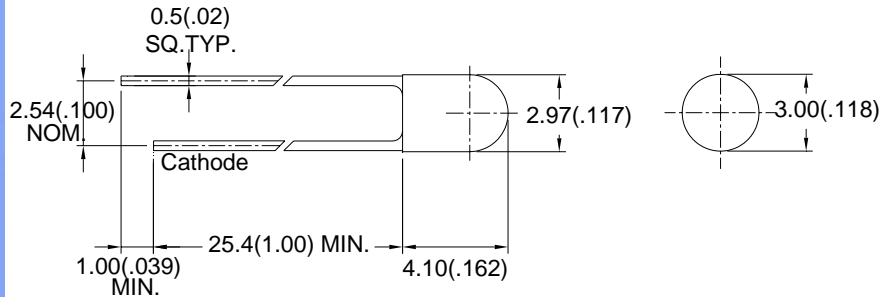

Unit: mm (inch)

Part No.	Emitted Color	λd (nm)	Lens Appearance	Vf(V) @ I _F =20mA		IV(mcd) @ I _F =20mA	Viewing Angle 2θ _{1/2} (deg)
				Typ	Max	Typ	
BL-B2141N	Yellow Green	566-576	Color Diffused	2.2	2.6	50	55
BL-B3341N	Yellow	580-595	Transparent	2.1	2.6	70	50
BL-B4341N	Red	625-638	Transparent	2.0	2.6	60	50

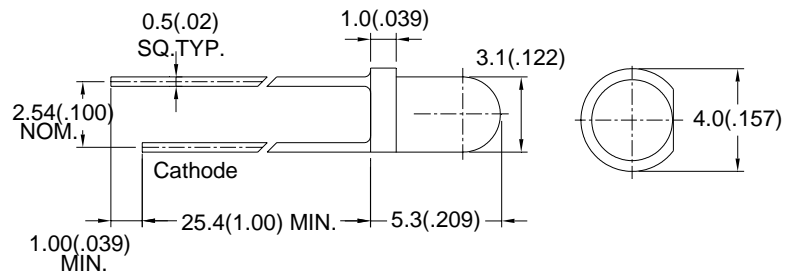

Unit: mm (inch)

Part No.	Emitted Color	λd (nm)	Lens Appearance	Vf(V) @ I _F =20mA		IV(mcd) @ I _F =20mA	Viewing Angle 2θ _{1/2} (deg)
				Typ	Max	Typ	
BL-BBX1V1A	Blue	460-475	Color Diffused	3.2	3.6	340	35
BL-B3141A	Yellow	580-595	Color Diffused	2.1	2.6	35	35
BL-BSB1V1A	Red	638-648	Color Diffused	1.8	2.6	50	35

3MM ROUND TYPE

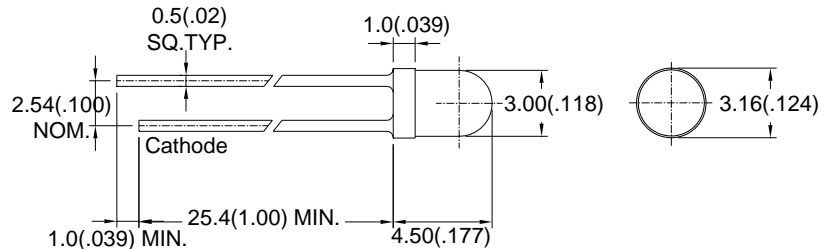

Unit: mm (inch)

Part No.	Emitted Color	λd (nm)	Lens Appearance	Vf(V) @ I _F =20mA		IV(mcd) @ I _F =20mA	Viewing Angle 2θ _{1/2} (deg)
				Typ	Max	Typ	
BL-BB53V1K	Blue	460-475	Transparent	3.2	3.6	1500	30
BL-BGE3V1K	Yellow Green	566-576	Transparent	2.0	2.6	465	30
BL-BKC1V1K	Yellow	586-594	Color Diffused	2.0	2.6	560	45
BL-BJE5V1K	Orange Red	615-628	Color Diffused	2.0	2.6	500	45
BL-BUB3V1K	Red	624-634	Transparent	2.0	2.6	700	30
BL-BZ53V1K	White	X=0.32.Y=0.31	Transparent	3.2	3.6	2700	30

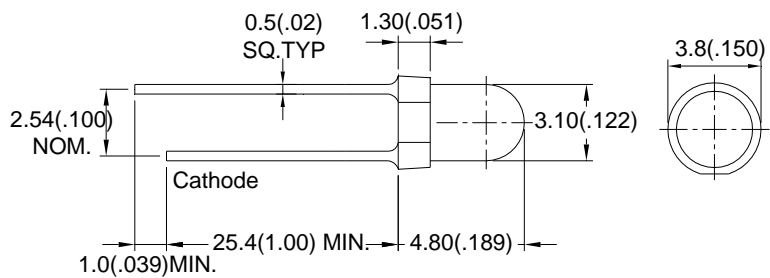

Unit: mm (inch)

Part No.	Emitted Color	λd (nm)	Lens Appearance	Vf(V) @ I _F =20mA		IV(mcd) @ I _F =20mA	Viewing Angle 2θ _{1/2} (deg)
				Typ	Max	Typ	
BL-BG83V1Q	Green	520-535	Transparent	3.2	3.6	5000	35
BL-B2141Q	Yellow Green	566-576	Color Diffused	2.2	2.6	40	35
BL-BKC341Q	Yellow	586-594	Transparent	2.0	2.6	1400	35
BL-B8341Q	Amber	600-615	Transparent	2.0	2.6	100	35
BL-BJE341Q	Orange Red	615-628	Transparent	2.0	2.6	1000	35

3MM ROUND TYPE

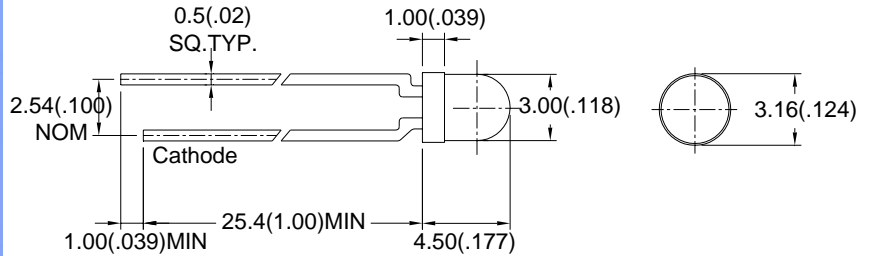

Unit: mm (inch)

Part No.	Emitted Color	λd (nm)	Lens Appearance	Vf(V) @ $I_F=20mA$		IV(mcd) @ $I_F=20mA$	Viewing Angle $2\theta_{1/2}$ (deg)
				Typ	Max	Typ	
BL-B2181K-3	Yellow Green	566-576	Color Diffused	2.2	2.6	35	65
BL-BGE181K-3	Yellow Green	566-576	Color Diffused	2.0	2.6	100	65
BL-B3181K-3	Yellow	580-595	Color Diffused	2.1	2.6	40	65
BL-BKC181K-3	Yellow	586-594	Color Diffused	2.0	2.6	350	65
BL-BUB181K-3	Red	624-634	Color Diffused	2.0	2.6	280	65

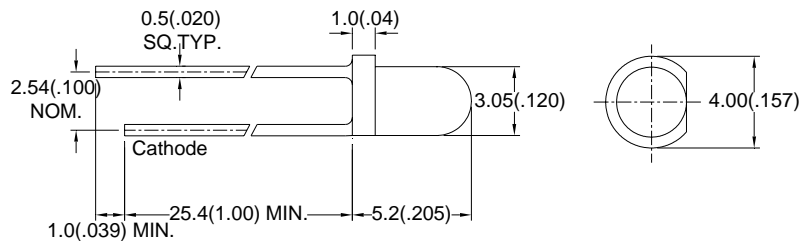

Unit: mm (inch)

Part No.	Emitted Color	λd (nm)	Lens Appearance	Vf(V) @ $I_F=20mA$		IV(mcd) @ $I_F=20mA$	Viewing Angle $2\theta_{1/2}$ (deg)
				Typ	Max	Typ	
BL-BB53V1X	Blue	460-475	Transparent	3.2	3.6	1200	35
BL-BG83V1X	Green	520-535	Transparent	3.2	3.6	4400	35
BL-BJL391X	Orange Red	620-630	Transparent	2.1	2.6	4800	30
BL-BJY541X	Orange Red	620-630	Color Diffused	2.0	2.6	700	65

3MM ROUND TYPE

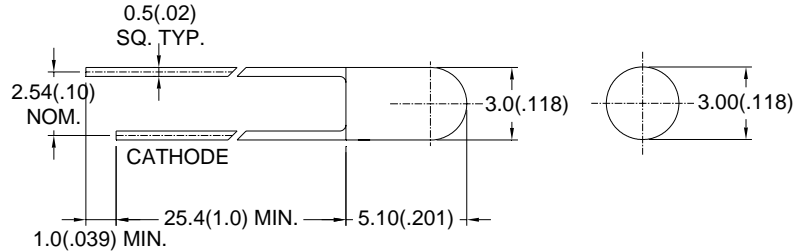

Unit: mm (inch)

Part No.	Emitted Color	λd (nm)	Lens Appearance	Vf(V) @ $I_F=20mA$		IV(mcd) @ $I_F=20mA$	Viewing Angle $2\theta_{1/2}$ (deg)
				Typ	Max	Typ	
BL-BB53V1J	Blue	460-475	Transparent	3.2	3.6	2100	30
BL-BG83V1J	Green	520-535	Transparent	3.2	3.6	6500	30
BL-B21V1J	Yellow Green	566-576	Color Diffused	2.2	2.6	40	35
BL-BKC341J	Yellow	586-594	Transparent	2.0	2.6	750	30
BL-BJE3V1J	Orange Red	615-628	Transparent	2.0	2.6	1000	30
BL-BUB1V1J	Red	624-634	Color Diffused	2.0	2.6	317	35
BL-B45V1J	Red	625-638	Color Diffused	2.0	2.6	35	35
BL-BZD3V1J	White	X=0.32,Y=0.31	Transparent	3.2	3.6	4060	30

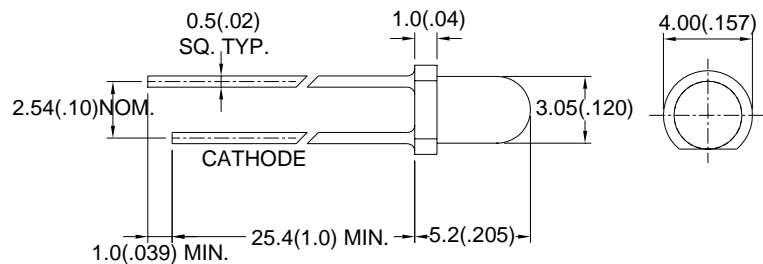

Unit: mm (inch)

Part No.	Emitted Color	λd (nm)	Lens Appearance	Vf(V) @ $I_F=20mA$		IV(mcd) @ $I_F=20mA$	Viewing Angle $2\theta_{1/2}$ (deg)
				Typ	Max	Typ	
BL-BGJ341F	Yellow Green	566-576	Transparent	2.0	2.6	420	40
BL-B31V1F	Yellow	580-595	Color Diffused	2.1	2.6	40	50

3MM ROUND TYPE

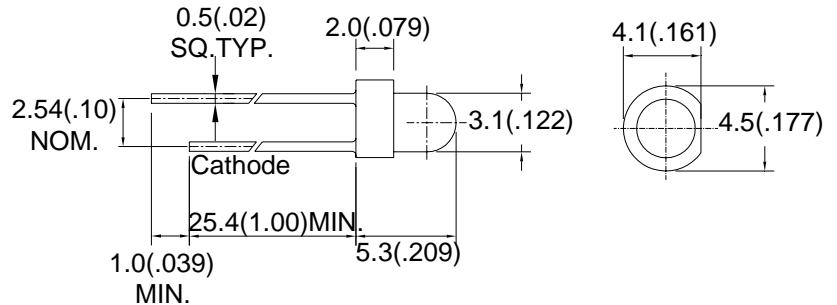

Unit: mm (inch)

Part No.	Emitted Color	λd (nm)	Lens Appearance	Vf(V) @ I _F =20mA		IV(mcd) @ I _F =20mA	Viewing Angle 2θ _{1/2} (deg)
				Typ	Max	Typ	
BL-BB51V1L	Blue	460-475	Color Diffused	3.2	3.6	380	45
BL-B2141L	Yellow Green	566-576	Color Diffused	2.2	2.6	35	45
BL-B3141L	Yellow	580-595	Color Diffused	2.1	2.6	40	45
BL-B4541L	Red	625-638	Color Diffused	2.1	2.6	35	45
BL-BSA3V1L	Red	638-648	Transparent	1.8	2.6	90	40

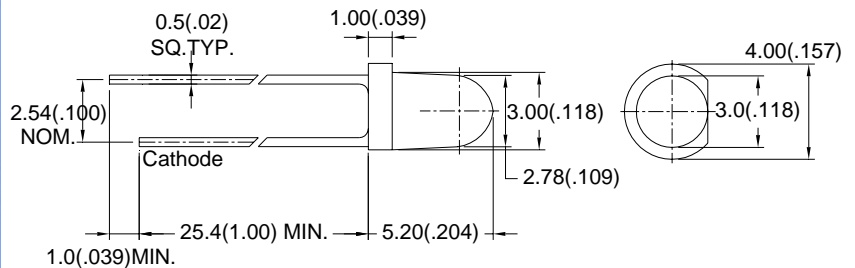

Unit: mm (inch)

Part No.	Emitted Color	λd (nm)	Lens Appearance	Vf(V) @ I _F =20mA		IV(mcd) @ I _F =20mA	Viewing Angle 2θ _{1/2} (deg)
				Typ	Max	Typ	
BL-BJX3V1M	Red	620-630	Transparent	2.0	2.6	18000	20
BL-BUF4V1M	Red	625-637	Color Transparent	2.1	2.6	1200	15
BL-BD03V1M	Red	638-648	Transparent	1.8	2.6	340	15

3MM ROUND TYPE

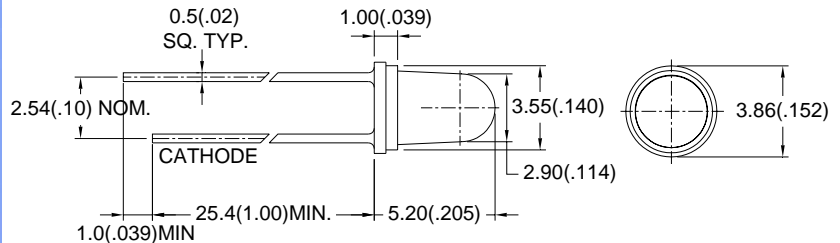

Unit: mm (inch)

Part No.	Emitted Color	λd (nm)	Lens Appearance	Vf(V) @ I _F =20mA		IV(mcd) @ I _F =20mA	Viewing Angle 2θ _{1/2} (deg)
				Typ	Max	Typ	
BL-BB53V1T	Blue	460-475	Transparent	3.2	3.6	1750	30
BL-B2441T	Yellow Green	566-576	Color Transparent	2.2	2.6	80	30
BL-B31V1T	Yellow	580-595	Color Diffused	2.1	2.6	40	45
BL-BJE3V1T	Orange Red	615-628	Transparent	2.0	2.6	900	30
BL-B4541T	Red	625-638	Color Diffused	2.1	2.6	35	45

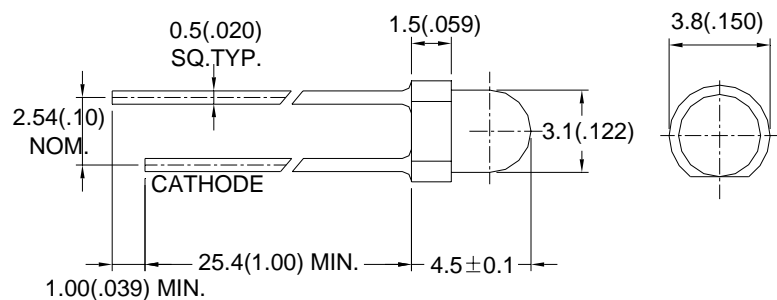

Unit: mm (inch)

Part No.	Emitted Color	λd (nm)	Lens Appearance	Vf(V) @ I _F =20mA		IV(mcd) @ I _F =20mA	Viewing Angle 2θ _{1/2} (deg)
				Typ	Max	Typ	
BL-BB53V1W	Blue	460-475	Transparent	3.2	3.6	1500	30
BL-B2141W	Yellow Green	566-576	Color Diffused	2.2	2.6	50	40
BL-B4641W	Red	625-638	Color Transparent	2.0	2.6	100	40
BL-BZD3V1W	White	X=0.32, Y=0.31	Transparent	3.2	3.6	2500	30

3MM ROUND TYPE

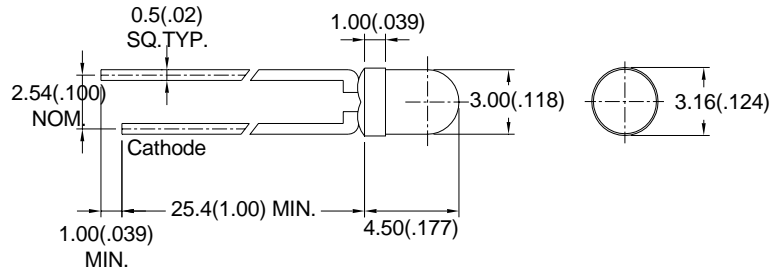

Unit: mm (inch)

Part No.	Emitted Color	λd (nm)	Lens Appearance	Vf(V) @ I _F =20mA		IV(mcd) @ I _F =20mA	Viewing Angle 2θ _{1/2} (deg)
				Typ	Max	Typ	
BL-B2131K	Yellow Green	566-576	Color Diffused	2.2	2.6	60	45
BL-B3331K	Yellow	580-595	Transparent	2.1	2.6	65	30
BL-BD0131K	Red	638-648	Color Diffused	1.8	2.6	80	45

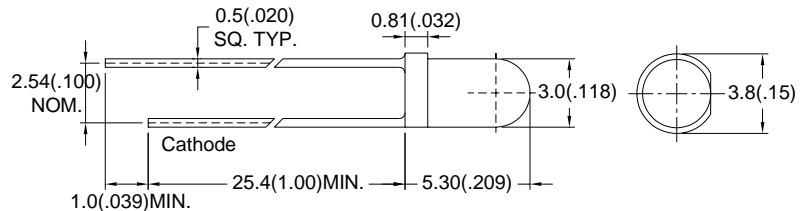

Unit: mm (inch)

Part No.	Emitted Color	λd (nm)	Lens Appearance	Vf(V) @ I _F =20mA		IV(mcd) @ I _F =20mA	Viewing Angle 2θ _{1/2} (deg)
				Typ	Max	Typ	
BL-BEG271	Red	617-638	White Diffused	2.1	2.6	13	45
	Yellow Green	566-576		2.2	2.6	13	
BL-BUBGE271	Red	624-634	White Diffused	2.0	2.6	110	45
	Yellow Green	566-576		2.0	2.6	45	
BL-BYY171	Yellow	580-595	Color Diffused	2.0	2.6	10	45
BL-BEE571	Red	617-638	Color Diffused	2.1	2.6	4.0	45

3MM ROUND TYPE

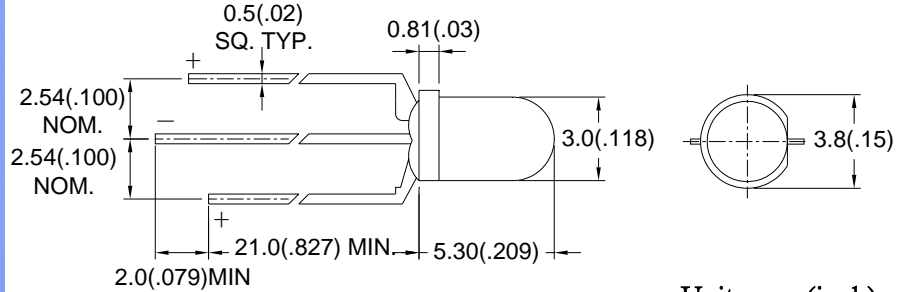

Unit: mm (inch)

Part No.	Emitted Color	λd (nm)	Lens Appearance	Vf(V) @ I _F =20mA		IV(mcd) @ I _F =20mA	Viewing Angle 2θ _{1/2} (deg)
				Typ	Max	Typ	
BL-BEG201	Red	617-638	White Diffused	2.0	2.6	30	40
	Yellow Green	566-576		2.2	2.6	35	
BL-BUBGE201	Red	624-634	White Diffused	2.0	2.6	220	40
	Yellow Green	566-576		2.0	2.6	100	

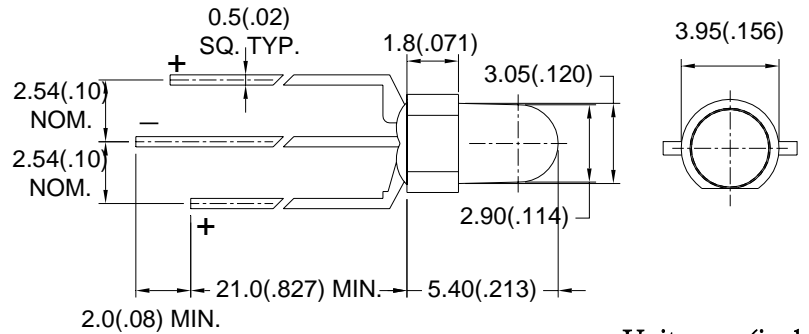

Unit: mm (inch)

Part No.	Emitted Color	λd (nm)	Lens Appearance	Vf(V) @ I _F =20mA		IV(mcd) @ I _F =20mA	Viewing Angle 2θ _{1/2} (deg)
				Typ	Max	Typ	
BL-BUBBD301G	Red	624-634	Transparent	2.0	2.6	1100	30
	Blue	460-475		3.2	3.6	500	
BL-BEG201G	Red	617-638	White Diffused	2.0	2.6	30	40
	Yellow Green	566-576		2.2	2.6	30	
BL-BJEB3201G	Orange Red	615-625	White Diffused	2.0	2.6	500	40
	Blue	460-475		3.2	3.6	250	

4MM ROUND TYPE

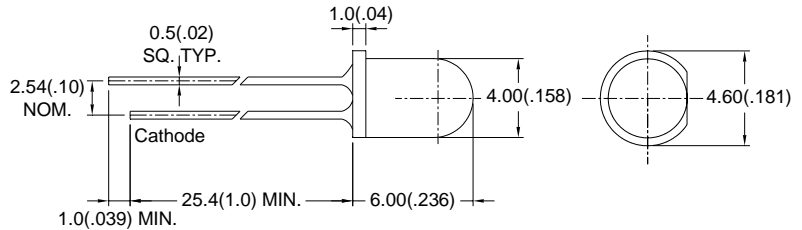

Unit: mm (inch)

Part No.	Emitted Color	λd (nm)	Lens Appearance	Vf(V) @ I _F =20mA		IV(mcd) @ I _F =20mA	Viewing Angle 2θ _{1/2} (deg)
				Typ	Max	Typ	
BL-B2132	Yellow Green	566-576	Color Diffused	2.2	2.6	40	55
BL-B4532	Red	625-638	Color Diffused	2.1	2.6	60	55

5MM ROUND TYPE

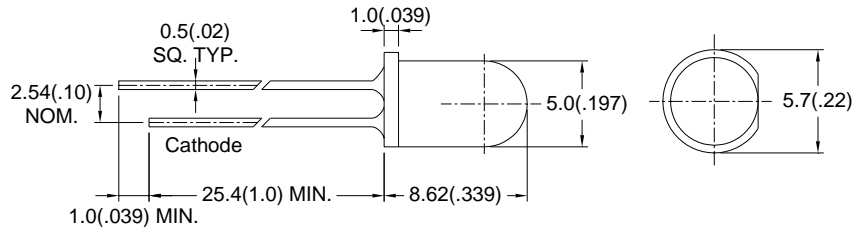

Unit: mm (inch)

Part No.	Emitted Color	λd (nm)	Lens Appearance	Vf(V) @ I _F =20mA		IV(mcd) @ I _F =20mA	Viewing Angle 2θ _{1/2} (deg)
				Typ	Max	Typ	
BL-BEG274	Red	617-638	White Diffused	2.0	2.6	10	50
	Yellow Green	566-576		2.2	2.6	20	
BL-BUFGE274	Red	625-637	White Diffused	2.1	2.6	150	50
	Yellow Green	566-576		2.2	2.6	48	
BL-BYG374	Yellow	580-595	Transparent	2.1	2.6	40	50
	Yellow Green	566-576		2.2	2.6	50	
BL-BKTG8274	Yellow	586-594	White Diffused	2.0	2.6	660	50
	Green	520-535		3.2	3.6	380	

5MM ROUND TYPE

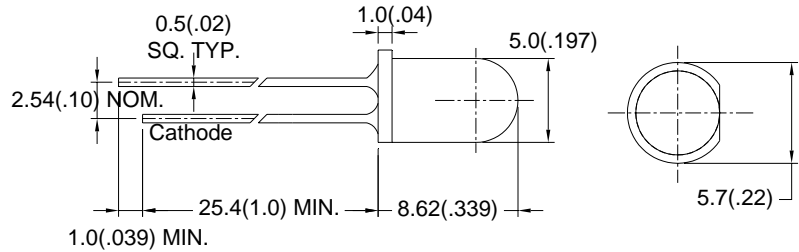
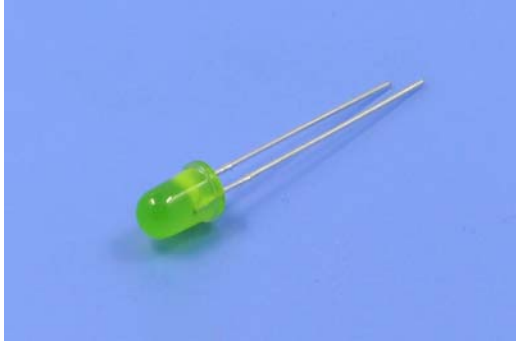

Unit: mm (inch)

Part No.	Emitted Color	λd (nm)	Lens Appearance	Vf(V) @ I _F =20mA		IV(mcd) @ I _F =20mA	Viewing Angle 2θ _{1/2} (deg)
				Typ	Max	Typ	
BL-BB51V4	Blue	460-475	Color Diffused	3.2	3.6	500	35
BL-B2134	Yellow Green	566-576	Color Diffused	2.2	2.6	40	35
BL-BGE334	Yellow Green	566-576	Transparent	2.0	2.6	1400	12
BL-B3134	Yellow	580-595	Color Diffused	2.1	2.6	35	35
BL-BKB334	Yellow	582-592	Transparent	2.1	2.6	3200	12
BL-BJC234	Amber	600-612	White Diffused	2.0	2.6	750	15
BL-BA1134	Amber	603-615	Color Diffused	2.1	2.6	60	35
BL-BJY534	Orange Red	620-630	Color Diffused	2.0	2.6	850	35
BL-BUF334	Red	625-637	Transparent	2.1	2.6	3600	12

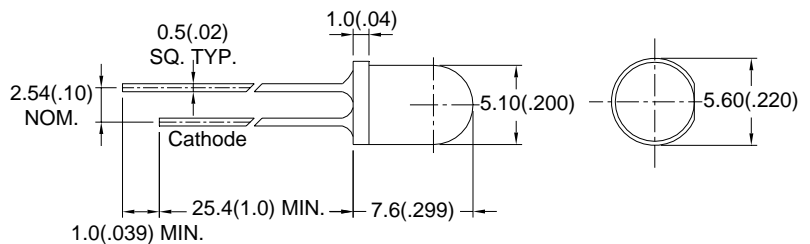

Unit: mm (inch)

Part No.	Emitted Color	λd (nm)	Lens Appearance	Vf(V) @ I _F =20mA		IV(mcd) @ I _F =20mA	Viewing Angle 2θ _{1/2} (deg)
				Typ	Max	Typ	
BL-B2134Q	Yellow Green	566-576	Color Diffused	2.2	2.6	80	55
BL-BUF134Q	Red	625-637	Color Diffused	2.1	2.6	280	55

5MM ROUND TYPE

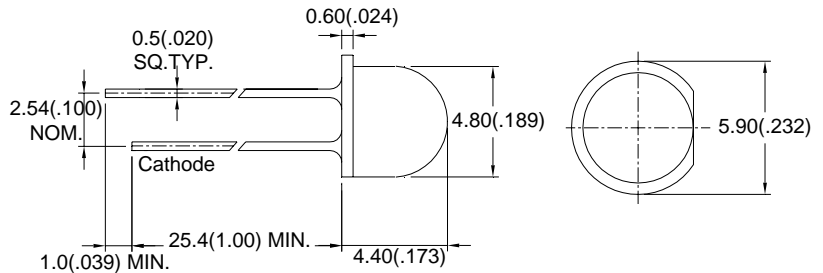

Unit: mm (inch)

Part No.	Emitted Color	λd (nm)	Lens Appearance	Vf(V) @ I _F =20mA		IV(mcd) @ I _F =20mA	Viewing Angle 2θ _{1/2} (deg)
				Typ	Max	Typ	
BL-BBE3K4B	Blue	460-475	Transparent	3.2	3.6	1600	60
BL-B4534B	Red	625-638	Color Diffused	2.1	2.6	25	30
BL-BUF334B	Red	625-637	Transparent	2.1	2.6	570	30

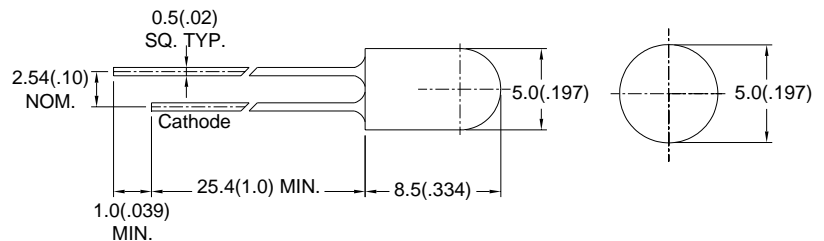

Unit: mm (inch)

Part No.	Emitted Color	λd (nm)	Lens Appearance	Vf(V) @ I _F =20mA		IV(mcd) @ I _F =20mA	Viewing Angle 2θ _{1/2} (deg)
				Typ	Max	Typ	
BL-BB31V4N	Blue	460-475	Color Diffused	3.2	3.6	600	35
BL-B2134N	Yellow Green	566-576	Color Diffused	2.2	2.6	45	40
BL-B3434N	Yellow	580-595	Color Transparent	2.1	2.6	210	20
BL-BKC134N	Yellow	586-594	Color Diffused	2.0	2.6	470	40
BL-BJY3V4N	Orange Red	620-630	Transparent	2.0	2.6	4200	20
BL-B4534N	Red	625-638	Color Diffused	2.1	2.6	40	40
BL-BUF334N	Red	625-637	Transparent	2.1	2.6	1100	20

5MM ROUND TYPE

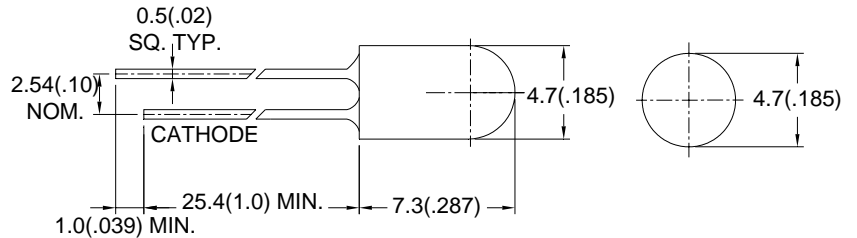
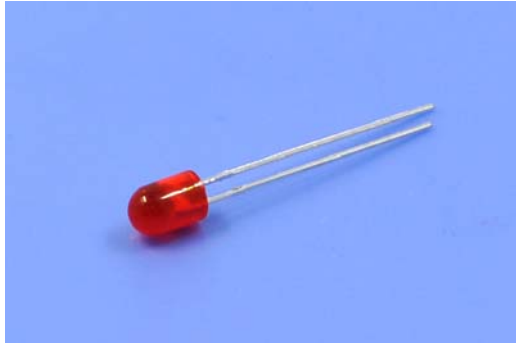

Unit: mm (inch)

Part No.	Emitted Color	λd (nm)	Lens Appearance	Vf(V) @ I _F =20mA		IV(mcd) @ I _F =20mA	Viewing Angle 2θ _{1/2} (deg)
				Typ	Max	Typ	
BL-B2133	Yellow Green	566-576	Color Diffused	2.2	2.6	45	40
BL-B3133	Yellow	580-595	Color Diffused	2.1	2.6	65	40
BL-B4533	Red	625-638	Color Diffused	2.1	2.6	65	40
BL-BUB1V3	Red	624-634	Color Diffused	2.0	2.6	320	60

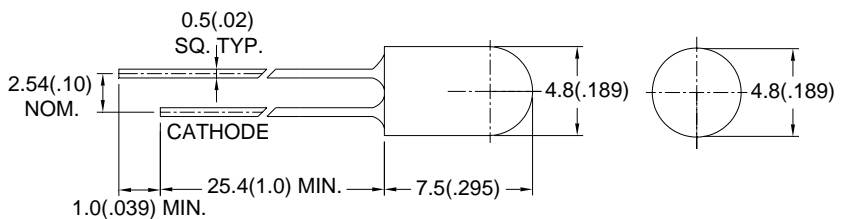
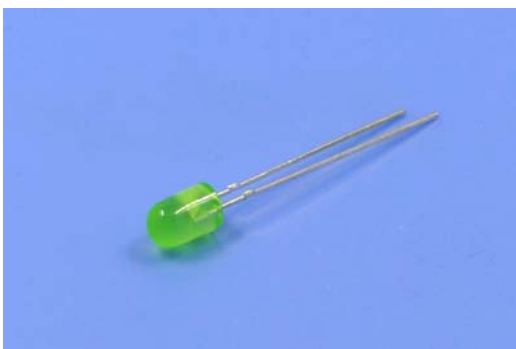

Unit: mm (inch)

Part No.	Emitted Color	λd (nm)	Lens Appearance	Vf(V) @ I _F =20mA		IV(mcd) @ I _F =20mA	Viewing Angle 2θ _{1/2} (deg)
				Typ	Max	Typ	
BL-BB51V3N	Blue	460-475	Color Diffused	3.2	3.6	660	40
BL-B2133N	Yellow Green	566-576	Color Diffused	2.2	2.6	45	40
BL-B3133N	Yellow	580-595	Color Diffused	2.1	2.6	60	40
BL-BUB333N	Red	624-634	Transparent	2.0	2.6	850	40
BL-B4533N	Red	625-638	Color Diffused	2.1	2.6	40	40

5MM ROUND TYPE

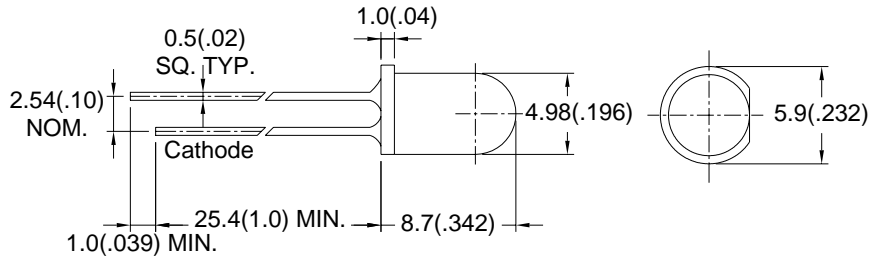

Unit: mm (inch)

Part No.	Emitted Color	λd (nm)	Lens Appearance	Vf(V) @ I _F =20mA		IV(mcd) @ I _F =20mA	Viewing Angle 2θ _{1/2} (deg)
				Typ	Max	Typ	
BL-BB31V4V	Blue	460-475	Color Diffused	3.2	3.6	700	35
BL-BGE1V4V	Yellow Green	566-576	Color Diffused	2.0	2.6	150	35
BL-BKC3V4V	Yellow	586-594	Transparent	2.0	2.6	4000	15
BL-BJZ3V4V	Orange Red	616-628	Transparent	2.0	2.6	8000	15
BL-BUF1V4V	Red	625-637	Color Diffused	2.1	2.6	470	35
BL-BUF3V4V	Red	625-637	Transparent	2.1	2.6	1570	15
BZ-BZD3V4V	White	X=0.32,Y=0.31	Transparent	3.2	3.6	8500	15

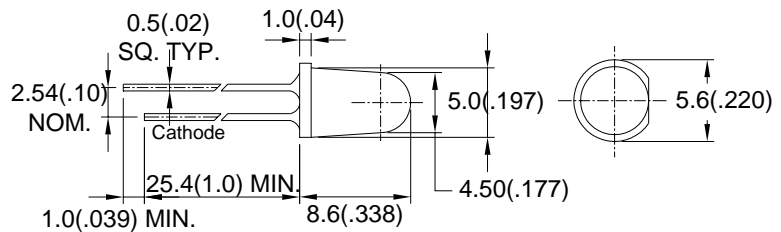

Unit: mm (inch)

Part No.	Emitted Color	λd (nm)	Lens Appearance	Vf(V) @ I _F =20mA		IV(mcd) @ I _F =20mA	Viewing Angle 2θ _{1/2} (deg)
				Typ	Max	Typ	
BL-BG63V7M	Green	515-535	Transparent	3.2	3.6	30000	8
BL-BD0337M	Red	638-648	Transparent	1.8	2.6	700	8

5MM ROUND TYPE

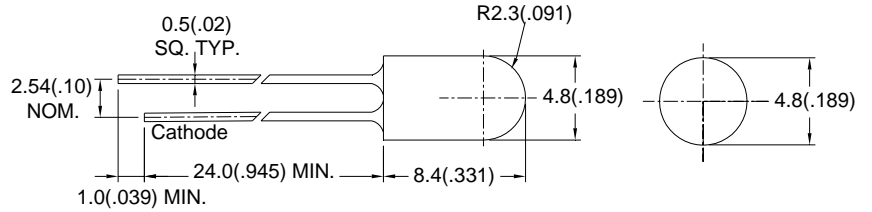

Unit: mm (inch)

Part No.	Emitted Color	λd (nm)	Lens Appearance	Vf(V) @ I _F =20mA		IV(mcd) @ I _F =20mA	Viewing Angle 2θ _{1/2} (deg)
				Typ	Max	Typ	
BL-BGE3V7H	Yellow Green	566-576	Transparent	2.0	2.6	210	60
BL-BJD5V7H	Orange Red	620-630	Color Diffused	2.1	2.6	300	70

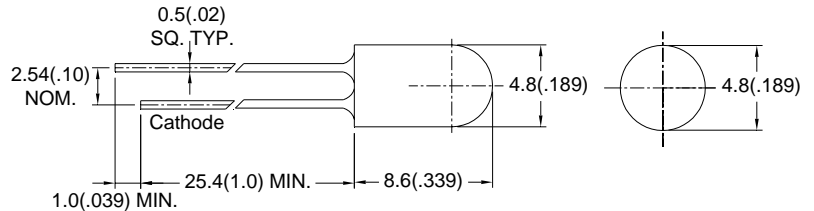

Unit: mm (inch)

Part No.	Emitted Color	λd (nm)	Lens Appearance	Vf(V) @ I _F =20mA		IV(mcd) @ I _F =20mA	Viewing Angle 2θ _{1/2} (deg)
				Typ	Max	Typ	
BL-BB53V7N	Blue	460-475	Transparent	3.2	3.6	3700	20
BL-B4537N	Red	625-638	Color Diffused	2.1	2.6	40	45
BL-BZ33V7N	White	X=0.32, Y=0.31	Water Clear	3.2	3.6	5800	20

5MM ROUND TYPE

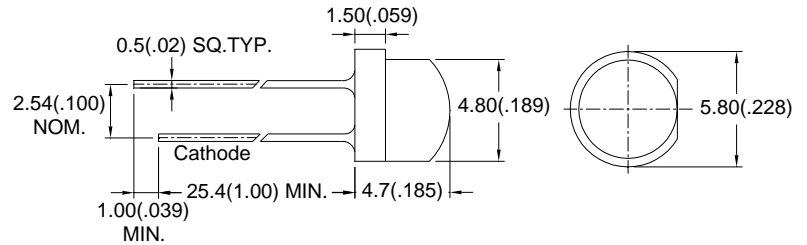

Unit: mm (inch)

Part No.	Emitted Color	λd (nm)	Lens Appearance	Vf(V) @ I _F =20mA		IV(mcd) @ I _F =20mA	Viewing Angle 2 θ 1/2 (deg)
				Typ	Max	Typ	
BL-BB539B	Blue	460-475	Transparent	3.2	3.6	400	50
BL-BG639B	Green	515-535	Transparent	3.2	3.6	4800	50
BL-BJE3VB	Orange Red	615-628	Transparent	2.0	2.6	200	120

5MM ROUND TYPE

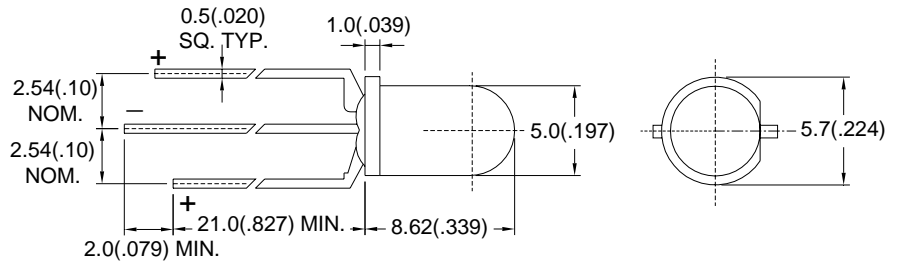

Unit: mm (inch)

Part No.	Emitted Color	λd (nm)	Lens Appearance	Vf(V) @ I _F =20mA		IV(mcd) @ I _F =20mA	Viewing Angle 2θ _{1/2} (deg)
				Typ	Max	Typ	
BL-BEG204	Red	617-638	White Diffused	2.1	2.6	35	50
	Yellow Green	566-576		2.2	2.6	35	
BL-BJEB3204	Orange Red	615-625	White Diffused	2.0	2.6	500	50
	Blue	460-475		3.2	3.6	270	

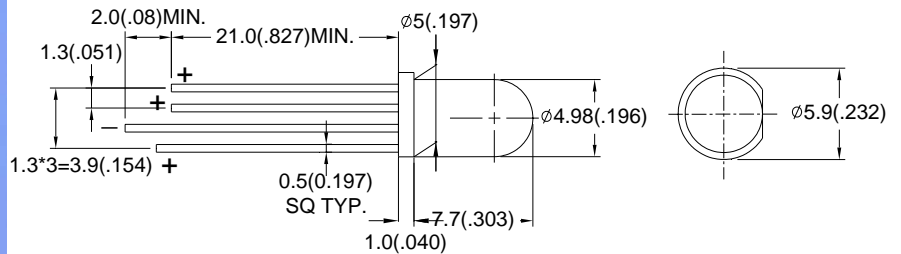

Unit: mm (inch)

Part No.	Emitted Color	λd (nm)	Lens Appearance	Vf(V) @ I _F =20mA		IV(mcd) @ I _F =20mA	Viewing Angle 2θ _{1/2} (deg)
				Typ	Max	Typ	
BL-BGEKCUF2C4V	Yellow Green	566-576	White Diffused	2.0	2.6	150	55
	Yellow	586-594		2.0	2.6	450	
	Red	625-637		2.1	2.6	300	
BL-BGKB5JE2C4V	Green	510-530	White Diffused	3.2	3.6	1180	55
	Blue	460-475		3.2	3.6	340	
	Orange Red	615-628		2.0	2.6	300	
BL-BG6B4J73C4V	Green	515-535	Transparent	3.2	3.6	4500	40
	Blue	460-475		3.2	3.6	600	
	Orange Red	615-630		2.2	2.6	1200	

BLINKING LAMP TYPE

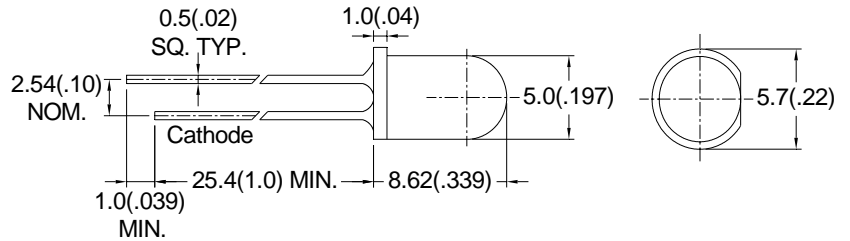

Unit: mm (inch)

Part No.	Emitted Color	λd (nm)	Lens Appearance	Pulse Rate(Hz) @VDD:5V			IV(mcd) @ $I_F=20mA$	Viewing Angle $2\theta_{1/2}$ (deg)
				Min	Typ	Max	Typ	
BB-BB5374	Blue	460-475	Transparent	2.0	2.4	2.8	90	40
BB-BGE374	Yellow Green	566-576	Transparent				30	40
BB-B4574	Red	625-638	Color Diffused				15	50
BB-BKC374	Yellow	586-594	Transparent				60	40

RESISTOR LAMP TYPE

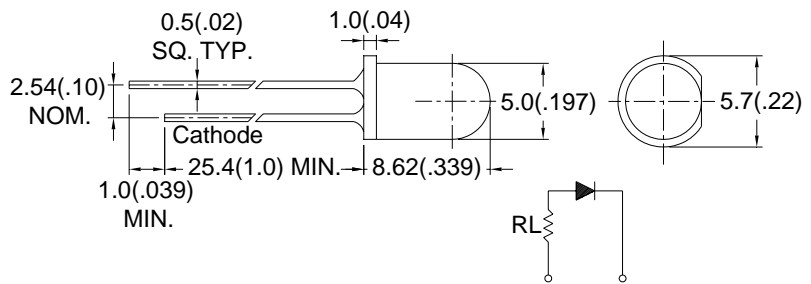

Unit: mm (inch)

Part No.	Emitted Color	λd (nm)	Lens Appearance	Operating Voltage (V)		Forward Current (mA)		IV(mcd) @ $I_F=20mA$	Viewing Angle $2\theta_{1/2}$ (deg)
				Typ	Max	Typ	Max	Typ	
BR-B2134-1-15V	Yellow Green	566-576	Color Diffused	-	15	11	14	45	40
BR-B3134-1-15V	Yellow	580-595	Color Diffused	-				13	40
BR-B4534-1-15V	Red	625-638	Color Diffused	-				60	40

8MM ROUND TYPE

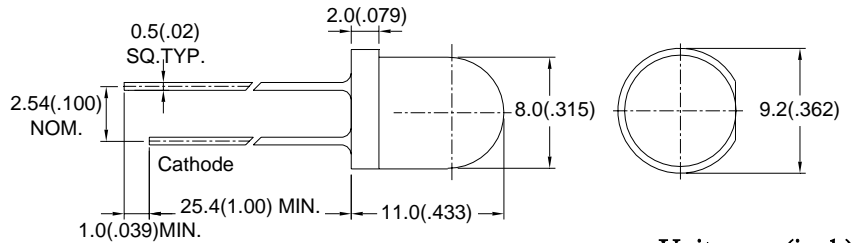
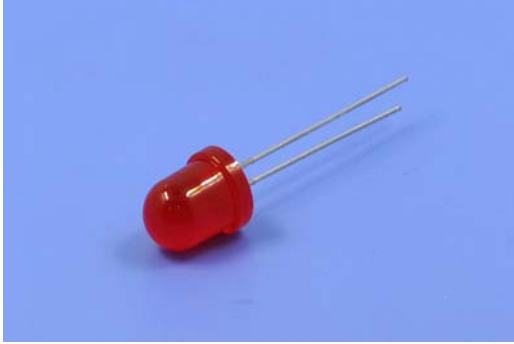

Unit: mm (inch)

Part No.	Emitted Color	λd (nm)	Lens Appearance	Vf(V) @ I _F =20mA		IV(mcd) @ I _F =20mA	Viewing Angle 2θ _{1/2} (deg)
				Typ	Max	Typ	
BL-B2139	Yellow Green	566-576	Color Diffused	2.2	2.6	30	45
BL-B3139	Yellow	580-595	Color Diffused	2.1	2.6	33	45
BL-B4539	Red	625-638	Color Diffused	2.1	2.6	32	45
BL-BJE539	Orange Red	615-628	Color Diffused	2.0	2.6	350	45

10MM ROUND TYPE

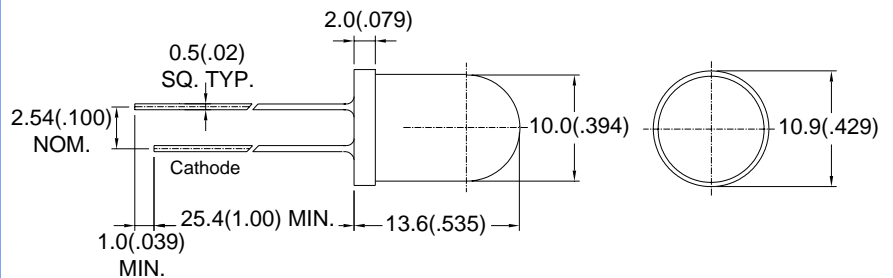

Unit: mm (inch)

Part No.	Emitted Color	λd (nm)	Lens Appearance	Vf(V) @ I _F =20mA		IV(mcd) @ I _F =20mA	Viewing Angle 2θ _{1/2} (deg)
				Typ	Max	Typ	
BL-B2130A	Yellow Green	566-576	Color Diffused	2.2	2.6	6.0	50
BL-BGE130A	Yellow Green	566-576	Color Diffused	2.0	2.6	18	50
BL-B4530A	Red	625-638	Color Diffused	2.1	2.6	10	50

RECTANGULAR

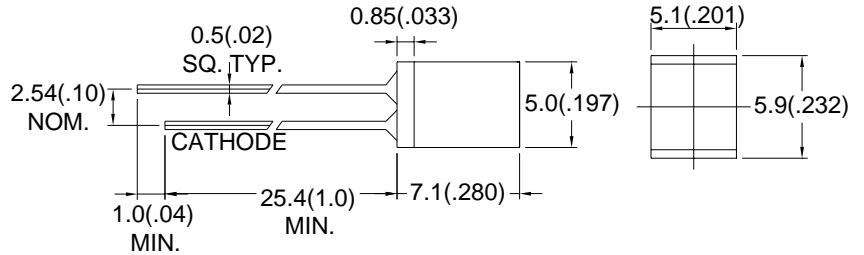
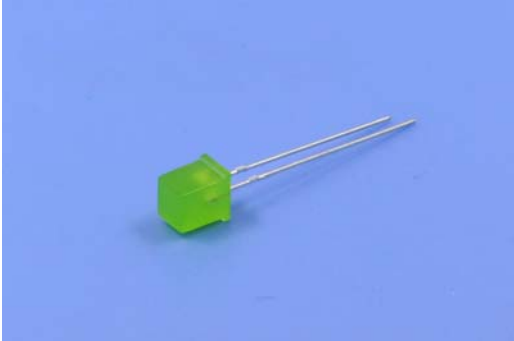

Unit: mm (inch)

Part No.	Emitted Color	λd (nm)	Lens Appearance	Vf(V) @ I _F =20mA		IV(mcd) @ I _F =20mA	Viewing Angle 2θ _{1/2} (deg)
				Typ	Max	Typ	
BL-R2130	Yellow Green	566-576	Color Diffused	2.2	2.6	9.0	150
BL-R3130	Yellow	580-595	Color Diffused	2.1	2.6	6.0	150

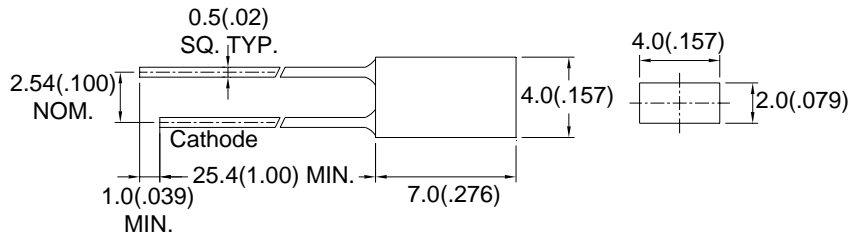

Unit: mm (inch)

Part No.	Emitted Color	λd (nm)	Lens Appearance	Vf(V) @ I _F =20mA		IV(mcd) @ I _F =20mA	Viewing Angle 2θ _{1/2} (deg)
				Typ	Max	Typ	
BL-R2131	Yellow Green	566-576	Color Diffused	2.2	2.6	7.0	120
BL-R3131	Yellow	580-595	Color Diffused	2.1	2.6	7.0	120
BL-R4531	Red	625-638	Color Diffused	2.0	2.6	7.0	120

RECTANGULAR

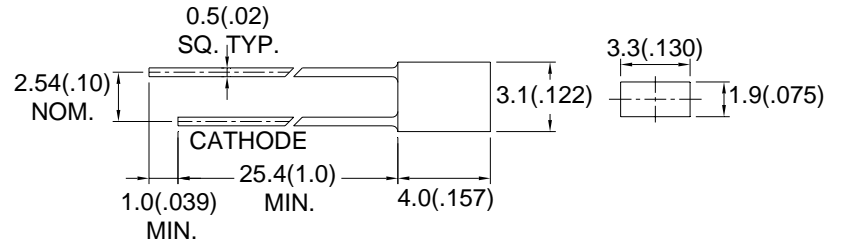
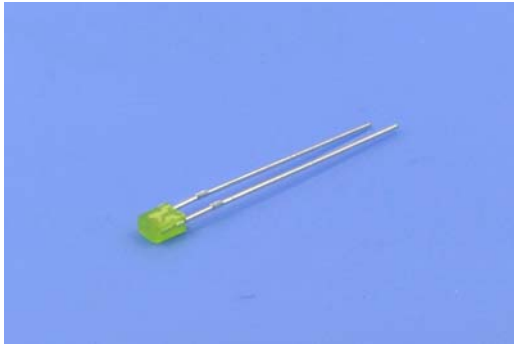

Unit: mm (inch)

Part No.	Emitted Color	λd (nm)	Lens Appearance	Vf(V) @ $I_F=20mA$		IV(mcd) @ $I_F=20mA$	Viewing Angle $2\theta_{1/2}$ (deg)
				Typ	Max	Typ	
BL-R2141F	Yellow Green	566-576	Color Diffused	2.2	2.6	20	100
BL-R31V1F	Yellow	580-595	Color Diffused	2.1	2.6	12	100
BL-RUB1V1F	Red	624-634	Color Diffused	2.0	2.6	80	100

RECTANGULAR

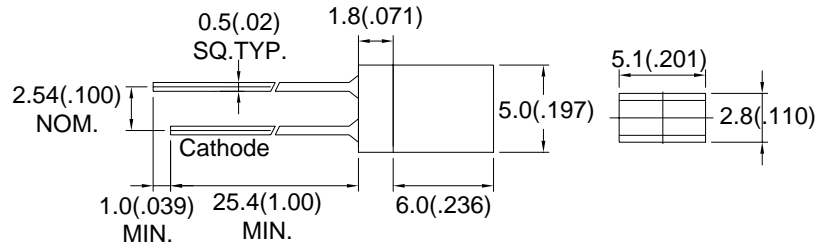

Unit: mm (inch)

Part No.	Emitted Color	λd (nm)	Lens Appearance	Vf(V) @ I _F =20mA		IV(mcd) @ I _F =20mA	Viewing Angle 2θ _{1/2} (deg)
				Typ	Max	Typ	
BL-R2132	Yellow Green	566-576	Color Diffused	2.2	2.6	5.0	120
BL-RGE132	Yellow Green	566-576	Color Diffused	2.0	2.6	20	120
BL-R4532	Red	625-638	Color Diffused	2.0	2.6	5.0	120

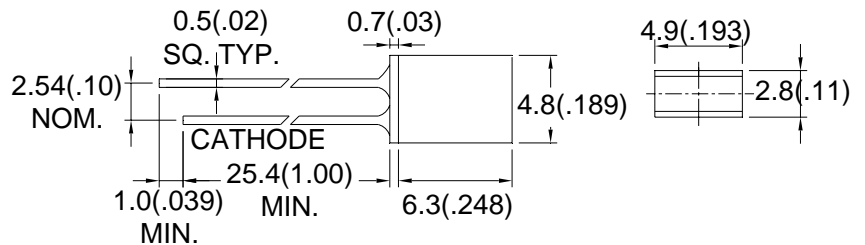

Unit: mm (inch)

Part No.	Emitted Color	λd (nm)	Lens Appearance	Vf(V) @ I _F =20mA		IV(mcd) @ I _F =20mA	Viewing Angle 2θ _{1/2} (deg)
				Typ	Max	Typ	
BL-R2132B	Yellow Green	566-576	Color Diffused	2.2	2.6	5.0	120
BL-R3132B	Yellow	580-595	Color Diffused	2.1	2.6	4.0	120
BL-R4532B	Red	625-638	Color Diffused	2.0	2.6	5.0	120

RECTANGULAR

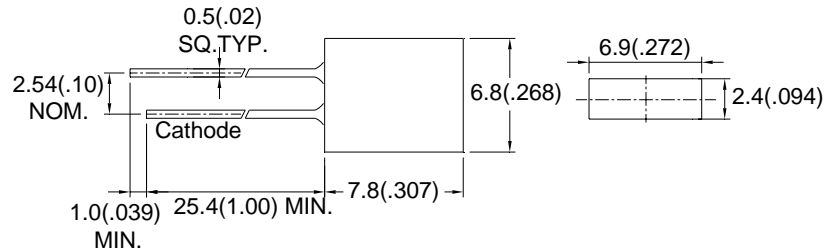
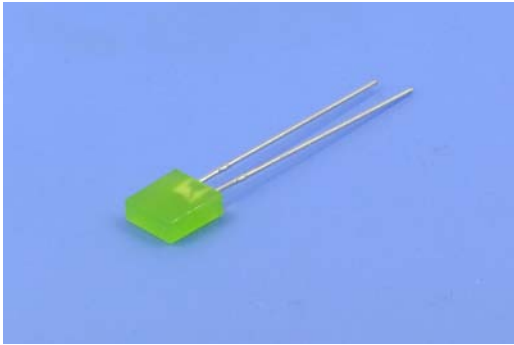

Unit: mm (inch)

Part No.	Emitted Color	λd (nm)	Lens Appearance	Vf(V) @ $I_F=20mA$		IV(mcd) @ $I_F=20mA$	Viewing Angle $2\theta_{1/2}$ (deg)
				Typ	Max	Typ	
BL-R2139A	Yellow Green	566-576	Color Diffused	2.2	2.6	4.5	130
BL-R3139A	Yellow	580-595	Color Diffused	2.1	2.6	4.0	130

RECTANGULAR

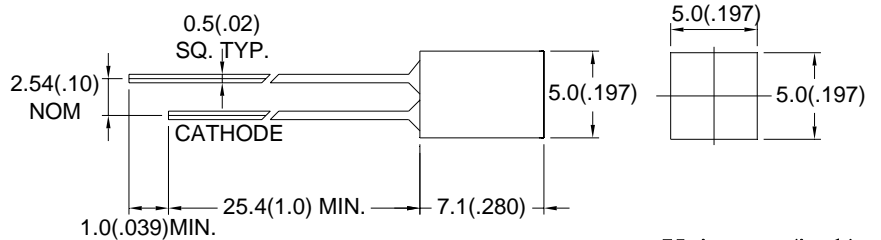
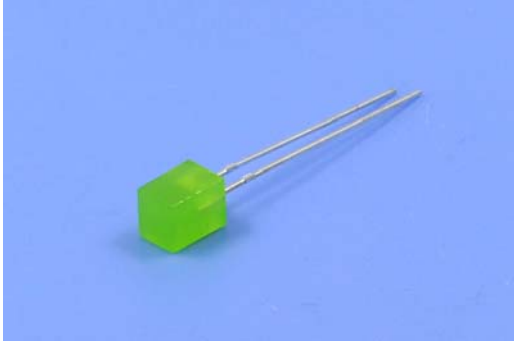

Unit: mm (inch)

Part No.	Emitted Color	λd (nm)	Lens Appearance	Vf(V) @ I _F =20mA		IV(mcd) @ I _F =20mA	Viewing Angle $2\theta_{1/2}$ (deg)
				Typ	Max	Typ	
BL-R2130N	Yellow Green	566-576	Color Diffused	2.2	2.6	5.0	150
BL-R3130N	Yellow	580-595	Color Diffused	2.1	2.6	6.0	150
BL-R4530N	Red	625-638	Color Diffused	2.0	2.6	8.0	150
BL-RUF130N	Red	625-637	Color Diffused	2.1	2.6	50	150

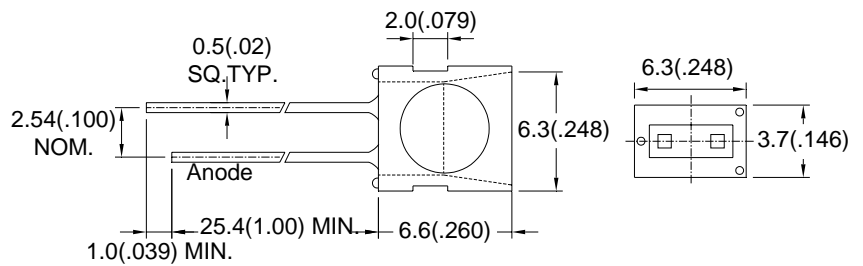
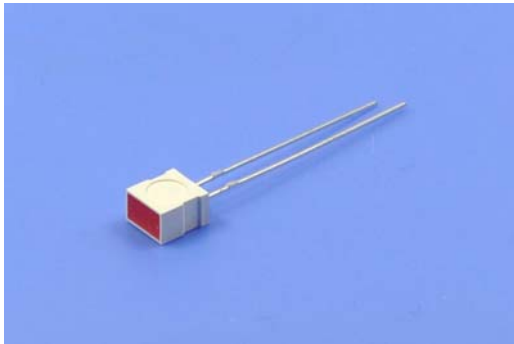

Unit: mm (inch)

Part No.	Emitted Color	λd (nm)	Lens Appearance	Vf(V) @ I _F =20mA		IV(mcd) @ I _F =20mA	Viewing Angle $2\theta_{1/2}$ (deg)
				Typ	Max	Typ	
BL-R213P	Yellow Green	566-576	Color Diffused	2.2	2.6	8.0	120
BL-R313P	Yellow	580-595	Color Diffused	2.1	2.6	7.0	120
BL-R453P	Red	625-638	Color Diffused	2.1	2.6	15	120

RECTANGULAR

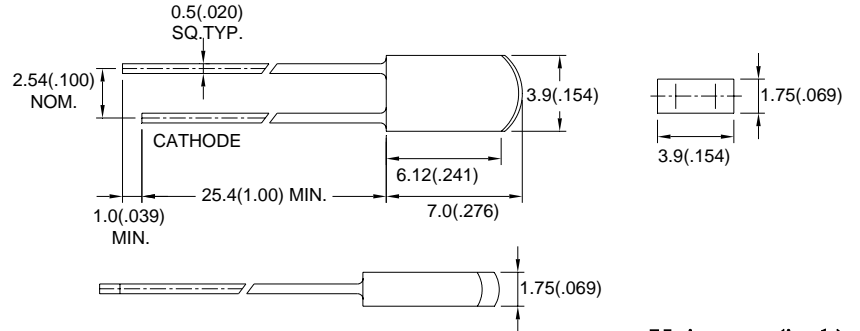

Unit: mm (inch)

Part No.	Emitted Color	λd (nm)	Lens Appearance	Vf(V) @ I _F =20mA		IV(mcd) @ I _F =20mA	Viewing Angle 2θ _{1/2} (deg)
				Typ	Max	Typ	
BL-R2144T	Yellow Green	566-576	Color Diffused	2.2	2.6	25	80
BL-R3144T	Yellow	580-595	Color Diffused	2.1	2.6	25	80
BL-RUF144T	Red	625-637	Color Diffused	2.1	2.6	130	80

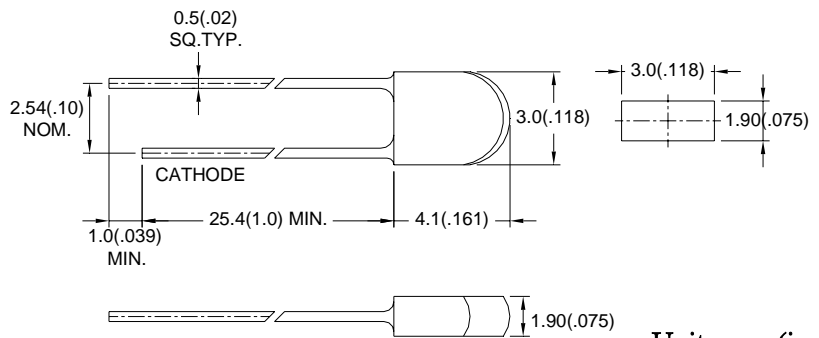

Unit: mm (inch)

Part No.	Emitted Color	λd (nm)	Lens Appearance	Vf(V) @ I _F =20mA		IV(mcd) @ I _F =20mA	Viewing Angle 2θ _{1/2} (deg)
				Typ	Max	Typ	
BL-RBX3N1U	Blue	460-475	Transparent	3.2	3.6	550	60
BL-R2141U-HS-NP-LGT	Yellow Green	566-576	Color Diffused	2.2	2.6	15	130
BL-R31V1U-HS-NP	Yellow	580-595	Color Diffused	2.1	2.6	15	135

CYLINDRICAL

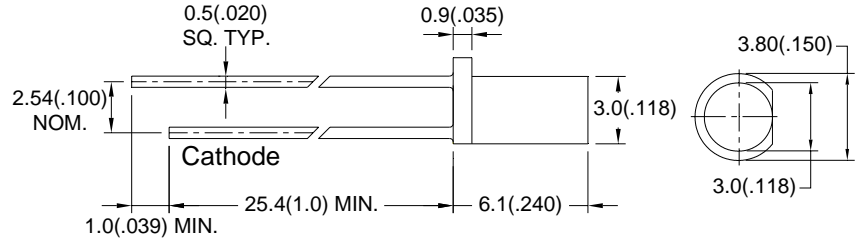

Unit: mm (inch)

Part No.	Emitted Color	λd (nm)	Lens Appearance	Vf(V) @ I _F =20mA		IV(mcd) @ I _F =20mA	Viewing Angle 2θ _{1/2} (deg)
				Typ	Max	Typ	
BL-CB41V2	Blue	460-475	Color Diffused	3.2	3.6	40	130
BL-C2142	Yellow Green	566-576	Color Diffused	2.2	2.6	7.0	130
BL-C3142	Yellow	580-595	Color Diffused	2.1	2.6	6.5	130

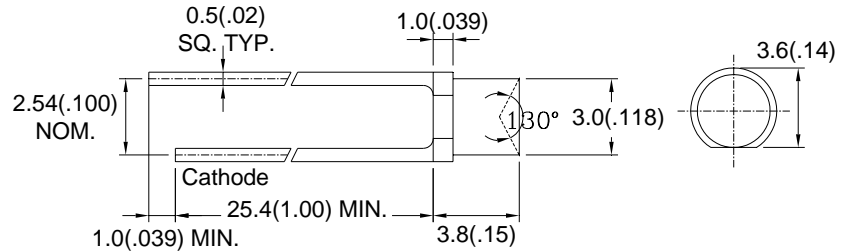

Unit: mm (inch)

Part No.	Emitted Color	λd (nm)	Lens Appearance	Vf(V) @ I _F =20mA		IV(mcd) @ I _F =20mA	Viewing Angle 2θ _{1/2} (deg)
				Typ	Max	Typ	
BL-CGE3V5	Yellow Green	566-576	Transparent	2.0	2.6	30	120
BL-CKC3V5	Yellow	584-594	Transparent	2.0	2.6	110	120
BL-CUB345	Red	624-634	Transparent	2.0	2.6	60	120

TOWER

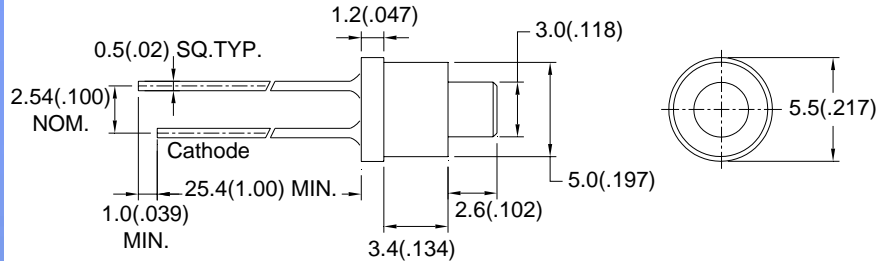

Unit: mm (inch)

Part No.	Emitted Color	λd (nm)	Lens Appearance	Vf(V) @ I _F =20mA		IV(mcd) @ I _F =20mA	Viewing Angle 2θ _{1/2} (deg)
				Typ	Max	Typ	
BL-SB52V2	Blue	460-475	White Diffused	3.2	3.6	55	100
BL-SGE132	Yellow Green	566-576	Color Diffused	2.0	2.6	13	100
BL-SKC132	Yellow	586-594	Color Diffused	2.0	2.6	60	100
BL-S4132	Red	625-638	Color Diffused	2.0	2.6	4.5	100

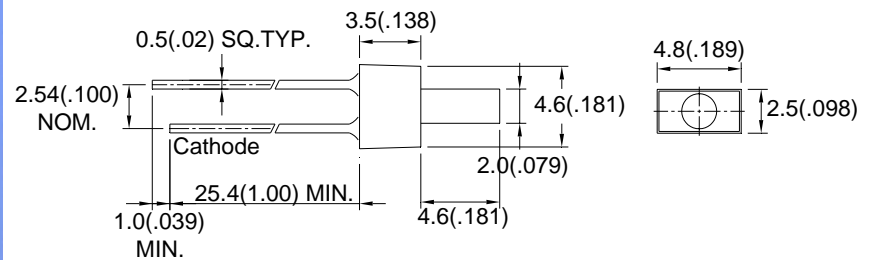

Unit: mm (inch)

Part No.	Emitted Color	λd (nm)	Lens Appearance	Vf(V) @ I _F =20mA		IV(mcd) @ I _F =20mA	Viewing Angle 2θ _{1/2} (deg)
				Typ	Max	Typ	
BL-SG63V6	Green	515-535	Transparent	3.2	3.6	2000	90
BL-S3136	Yellow	580-595	Color Diffused	2.1	2.6	6.0	70
BL-S4136	Red	625-638	Color Diffused	2.0	2.6	6.5	70

TRIANGULAR

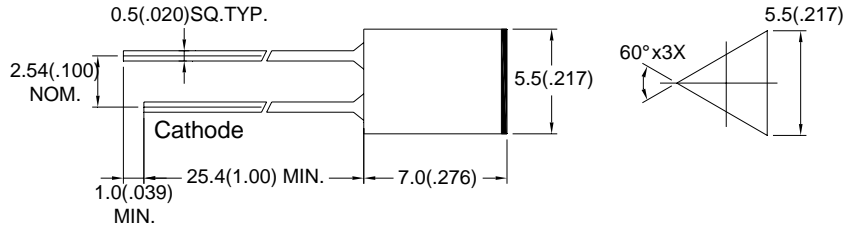

Unit: mm (inch)

Part No.	Emitted Color	λd (nm)	Lens Appearance	Vf(V) @ I _F =20mA		IV(mcd) @ I _F =20mA	Viewing Angle $2\theta_{1/2}$ (deg)
				Typ	Max	Typ	
BL-T3141-T	Yellow	580-595	Color Diffused	2.1	2.6	10	120
BL-T4531-T	Red	625-638	Color Diffused	2.0	2.6	6.5	120

ELLIPSE

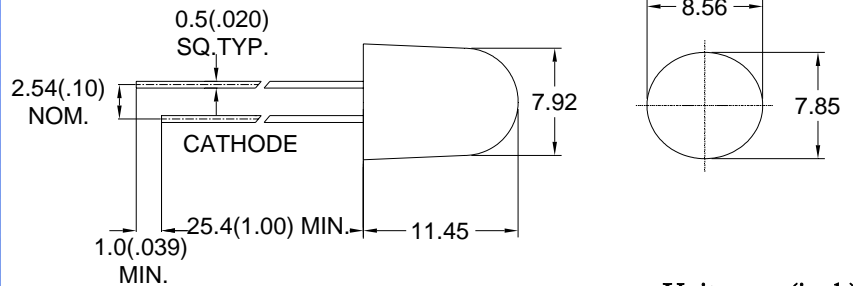

Unit: mm (inch)

Part No.	Emitted Color	λd (nm)	Lens Appearance	Vf(V) @ I _F =20mA		IV(mcd) @ I _F =20mA	Viewing Angle $2\theta_{1/2}$ (deg)
				Typ	Max	Typ	
BTL-WKT3R4J-1-LS	Yellow	586-594	Transparent	2.0	2.6	15000	30(X-X) 15(Y-Y)
BTL-WJL3R4J-1-LS	Orange Red	620-630	Transparent	2.1	2.6	20000	45(X-X) 20(Y-Y)
BTL-WJU3R4J-1-LS	Orange Red	620-630	Transparent	2.0	2.6	15000	30(X-X) 15(Y-Y)

HOLDER ASSEMBLY

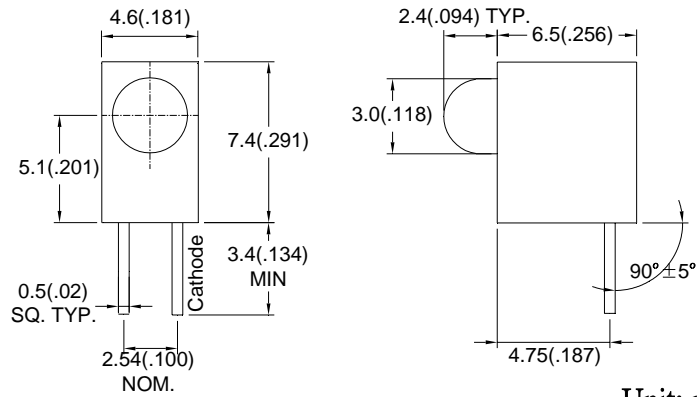
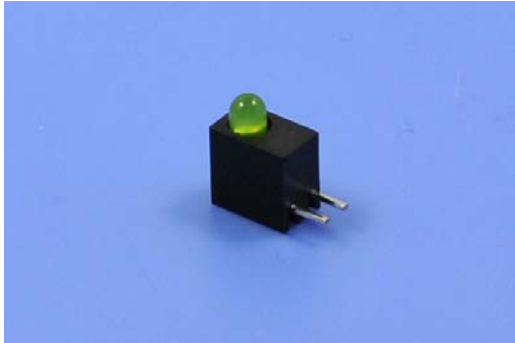

Unit: mm (inch)

Part No.	Emitted Color	λd (nm)	Lens Appearance	Vf(V) @ I _F =20mA		IV(mcd) @ I _F =20mA	Viewing Angle 2θ _{1/2} (deg)
				Typ	Max	Typ	
BL-C9/G-41K	Yellow Green	566-576	Color Diffused	2.2	2.6	35	45
BL-C9/I-41K	Red	625-638	Color Diffused	2.0	2.6	35	35
BL-C9/S-41K	Red	638-648	Color Diffused	1.8	2.6	50	35
BL-C9/Y-41K	Yellow	580-594	Color Diffused	2.1	2.6	45	35
BL-C9/B5-V1K	Blue	460-475	Color Diffused	3.2	3.6	340	35

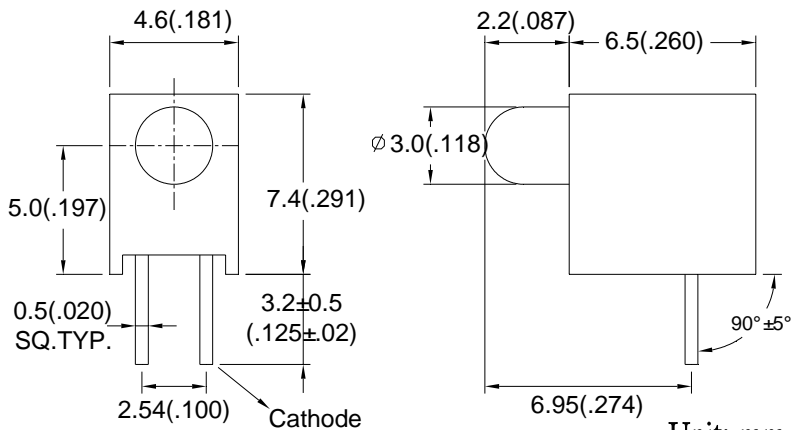
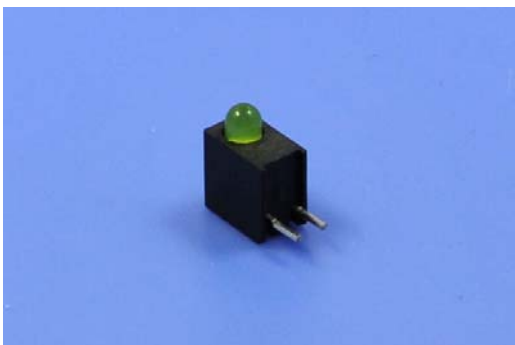

Unit: mm (inch)

Part No.	Emitted Color	λd (nm)	Lens Appearance	Vf(V) @ I _F =20mA		IV(mcd) @ I _F =20mA	Viewing Angle 2θ _{1/2} (deg)
				Typ	Max	Typ	
BL-C7C/G-V1J-AA-LC3.2-T10	Yellow Green	566-576	Color Diffused	2.0	2.5	20	35
BL-C7C/GJC-V1J-AA-LC3.2	Yellow Green	566-576	Transparent	2.0	2.6	690	30

HOLDER ASSEMBLY

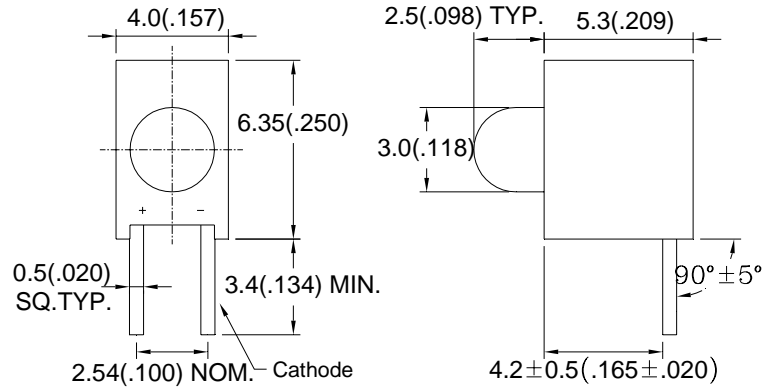
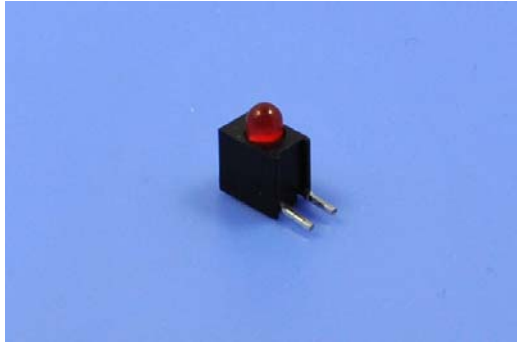

Unit: mm (inch)

Part No.	Emitted Color	λ d (nm)	Lens Appearance	Vf(V) @ I _F =20mA		IV(mcd) @ I _F =20mA	Viewing Angle 2θ _{1/2} (deg)
				Typ	Max	Typ	
BL-C32A/G-41K	Yellow Green	566-576	Color Diffused	2.2	2.6	35	45
BL-C32A/I-41K	Red	625-638	Color Diffused	2.0	2.6	35	45
BL-C32A/Y-41K	Yellow	580-594	Color Diffused	2.1	2.6	35	45

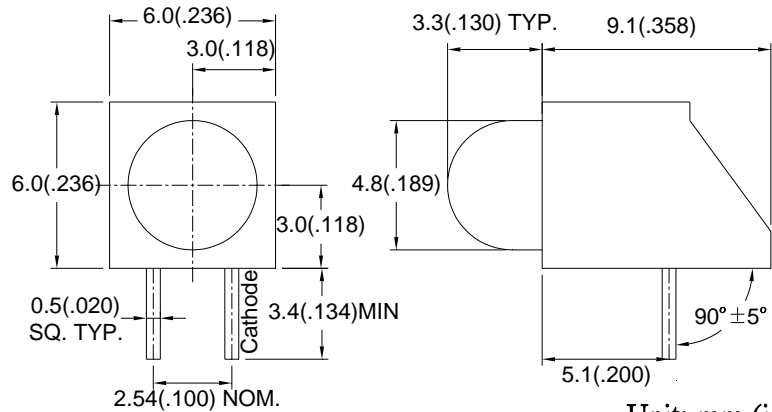
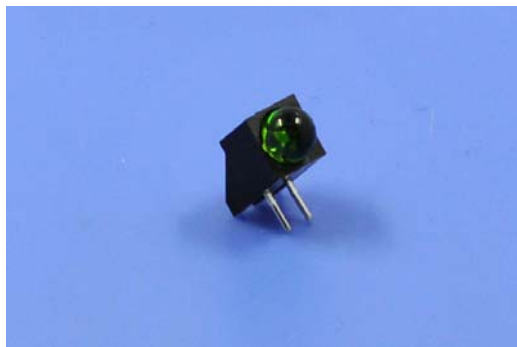

Unit: mm (inch)

Part No.	Emitted Color	λ d (nm)	Lens Appearance	Vf(V) @ I _F =20mA		IV(mcd) @ I _F =20mA	Viewing Angle 2θ _{1/2} (deg)
				Typ	Max	Typ	
BL-C41/G-33N	Yellow Green	566-576	Color Diffused	2.2	2.6	105	40
BL-C41/ST-33N	Red	638-648	Color Transparent	2.0	2.6	230	30
BL-C41-KB-V3N	Yellow	580-594	Color Diffused	2.1	2.6	300	40

HOLDER ASSEMBLY

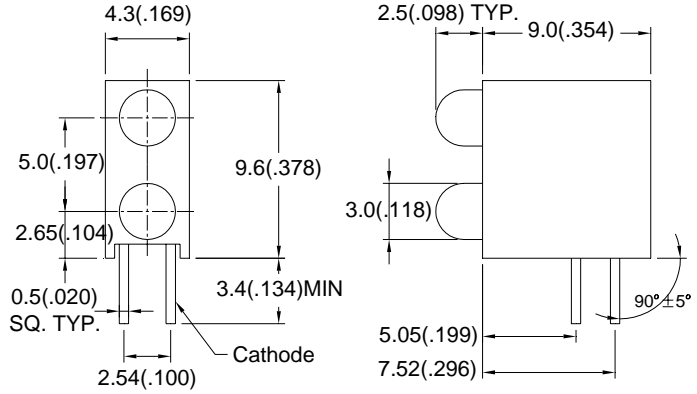
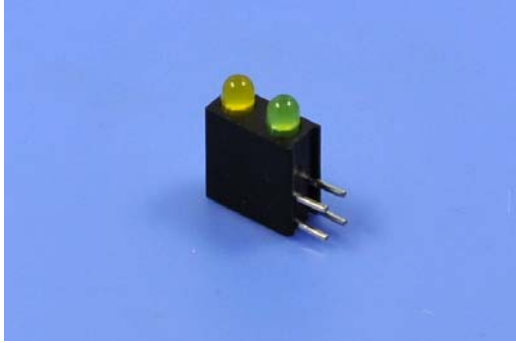

Unit: mm (inch)

Part No.	Emitted Color	λd (nm)	Lens Appearance	Vf(V) @ I _F =20mA		IV(mcd) @ I _F =20mA	Viewing Angle 2θ _{1/2} (deg)
				Typ	Max	Typ	
BL-C34/YG-41K	Yellow	580-595	Color Diffused	2.1	2.6	50	45
	Yellow Green	566-576		2.2	2.6	35	
BL-C34/2EGW-71K	Red	625-638	White Diffused	2.0	2.6	8	40
	Yellow Green	566-576		2.2	2.6	10	

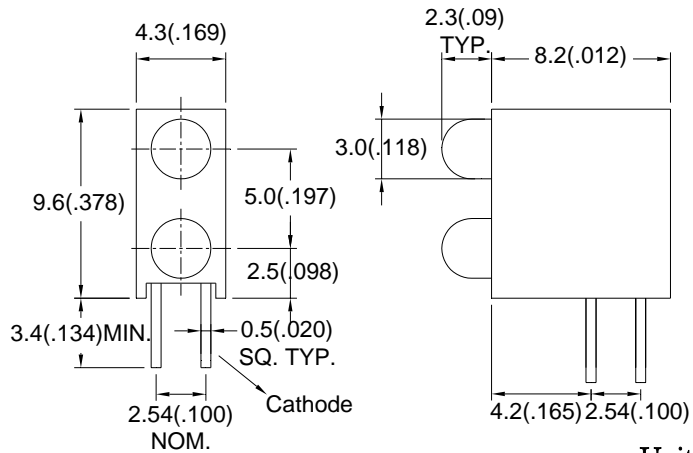
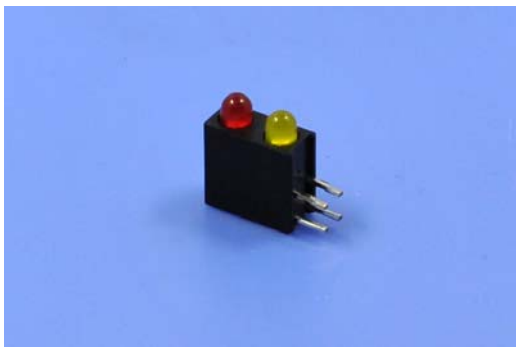

Unit: mm (inch)

Part No.	Emitted Color	λd (nm)	Lens Appearance	Vf(V) @ I _F =20mA		IV(mcd) @ I _F =20mA	Viewing Angle 2θ _{1/2} (deg)
				Typ	Max	Typ	
BL-C7H/IY-V1J-AA	Red	625-638	Color Diffused	2.1	2.6	35	35
	Yellow	580-595		2.1	2.6	45	
BL-C7H/NG-V1J-AA	Yellow Green	566-576	Color Diffused	2.2	2.6	40	35

HOLDER ASSEMBLY

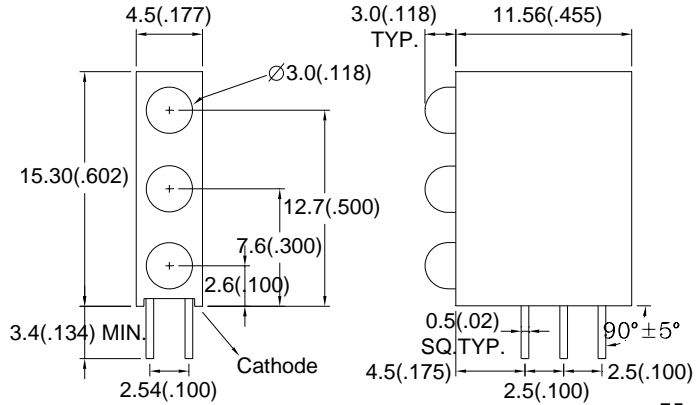
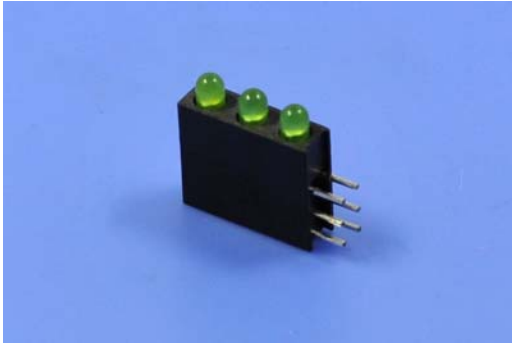

Unit: mm (inch)

Part No.	Emitted Color	λd (nm)	Lens Appearance	Vf(V) @ I _F =20mA		IV(mcd) @ I _F =20mA	Viewing Angle 2θ _{1/2} (deg)
				Typ	Max	Typ	
BL-C34M/3G-41J	Yellow Green	566-576	Color Diffused	2.1	2.6	40	30
BL-C34M/HGY-41J	Red	650	Color Diffused	2.3	2.6	3.5	35
	Yellow Green	566-576		2.1	2.6	40	
	Yellow	580-595		2.1	2.6	30	
BL-C34M/3Y-41J	Yellow	580-595	Color Diffused	2.1	2.6	45	35

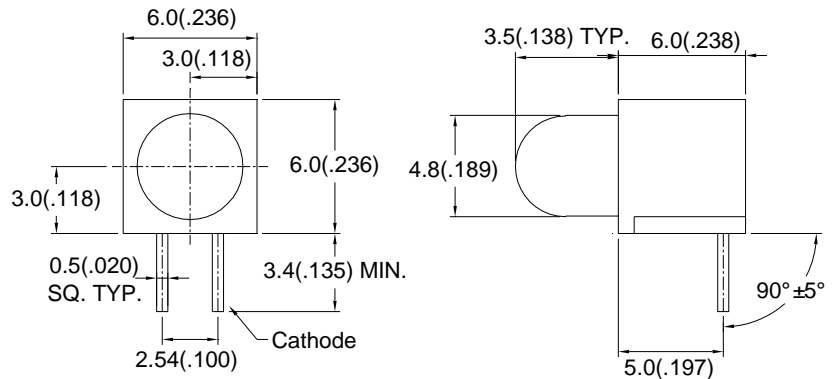
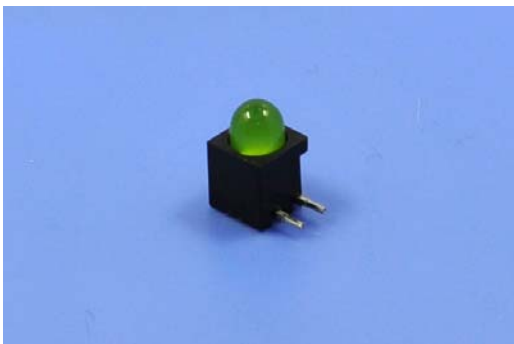

Unit: mm (inch)

Part No.	Emitted Color	λd (nm)	Lens Appearance	Vf(V) @ I _F =20mA		IV(mcd) @ I _F =20mA	Viewing Angle 2θ _{1/2} (deg)
				Typ	Max	Typ	
BL-C61/G-33N	Yellow Green	566-576	Color Diffused	2.2	2.6	45	40
BL-C61/H-33N	Red	650	Color Diffused	2.3	2.6	3.0	40

HOLDER ASSEMBLY

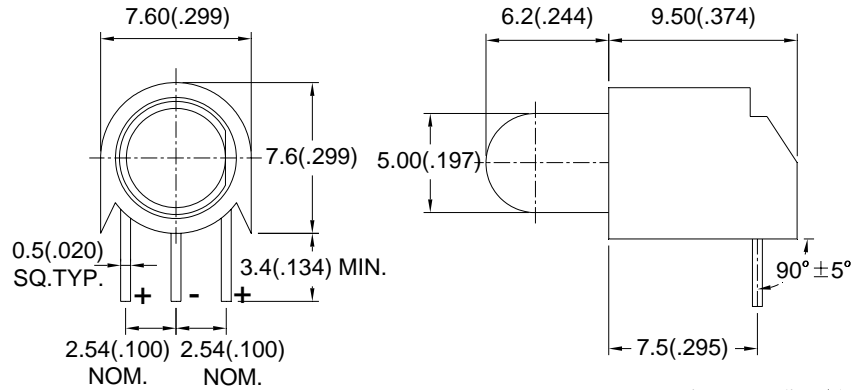

Unit: mm (inch)

Part No.	Emitted Color	λd (nm)	Lens Appearance	Vf(V) @ I _F =20mA		IV(mcd) @ I _F =20mA	Viewing Angle $2\theta_{1/2}$ (deg)
				Typ	Max	Typ	
BL-C36/EGW-04	Red	625-638	White Diffused	2.1	2.6	50	50
	Yellow Green	566-576		2.2	2.6	70	
BL-C36/YGW-04	Yellow	580-595	White Diffused	2.1	2.6	70	50
	Yellow Green	566-576		2.2	2.6	70	

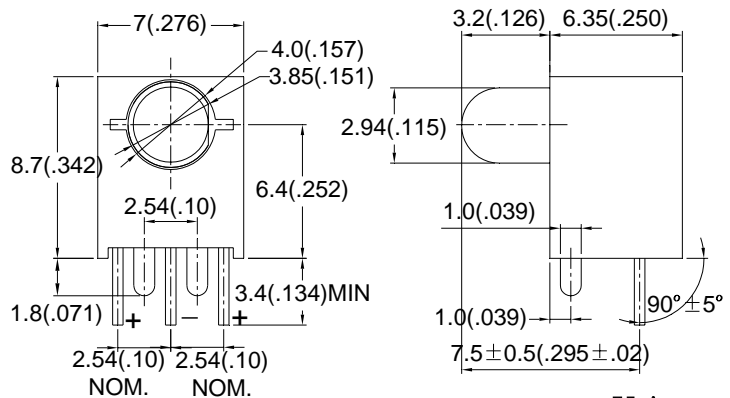
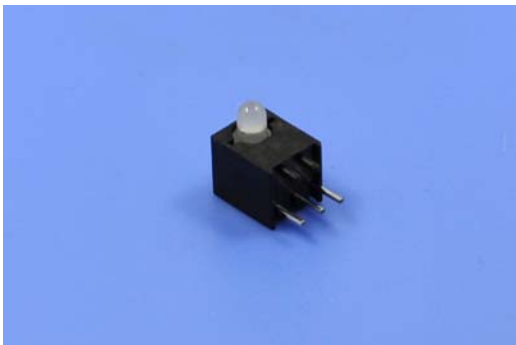

Unit: mm (inch)

Part No.	Emitted Color	λd (nm)	Lens Appearance	Vf(V) @ I _F =20mA		IV(mcd) @ I _F =20mA	Viewing Angle $2\theta_{1/2}$ (deg)
				Typ	Max	Typ	
BL-C36A/UBB3W-01G-NP-26F	Red	627-637	White Diffused	2.0	2.6	95	60
	Blue	460-475		3.2	3.6	180	
BL-C36A/JDGEW-01G	Orange Red	620-630	White Diffused	2.0	2.6	230	50
	Yellow Green	566-576		2.2	2.6	200	

HOLDER ASSEMBLY

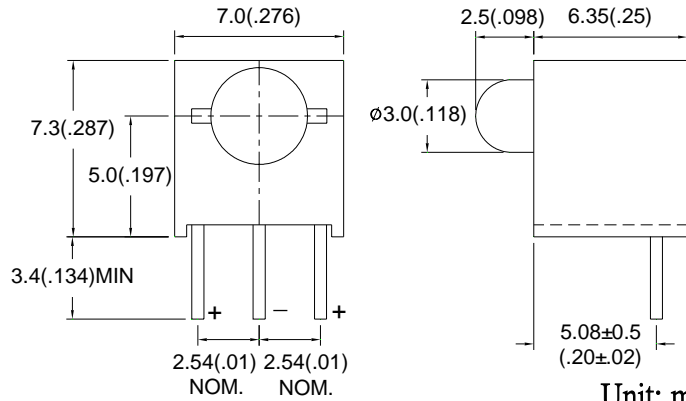
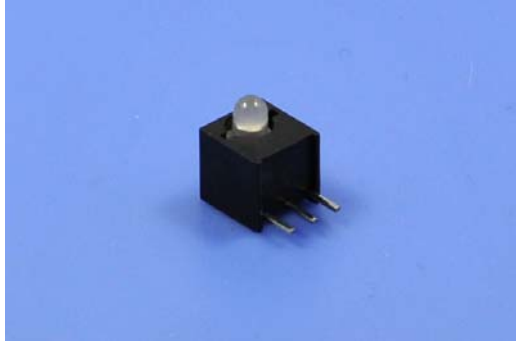

Unit: mm (inch)

Part No.	Emitted Color	λd (nm)	Lens Appearance	Vf(V) @ I _F =20mA		IV(mcd) @ I _F =20mA	Viewing Angle 2θ _{1/2} (deg)
				Typ	Max	Typ	
BL-C9V/GEUBW-01G	Yellow Green	566-576	White Diffused	2.0	2.6	225	40
	Red	625-637		2.0	2.6	400	

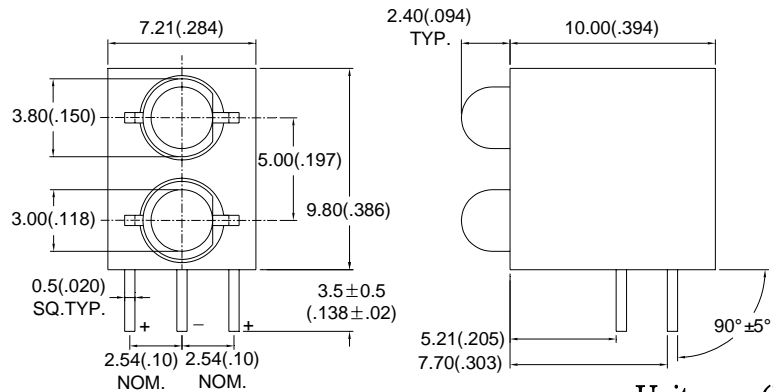

Unit: mm (inch)

Part No.	Emitted Color	λd (nm)	Lens Appearance	Vf(V) @ I _F =20mA		IV(mcd) @ I _F =20mA	Viewing Angle 2θ _{1/2} (deg)
				Typ	Max	Typ	
BL-C29E/2GYW-01-LC3.5	Yellow Green	566-576	White Diffused	2.2	2.6	35	40
	Yellow	580-594		2.2	2.6	30	
BL-C29E/2EGW-01-LC3.5	Red	617-638	White Diffused	2.0	2.6	35	40
	Yellow Green	566-576		2.2	2.6	35	

HOLDER ASSEMBLY

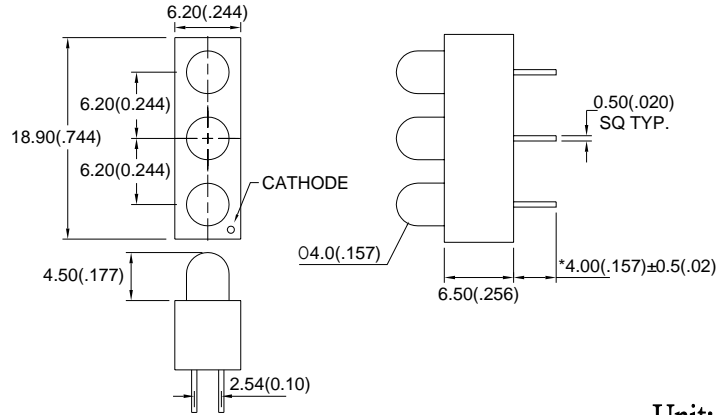
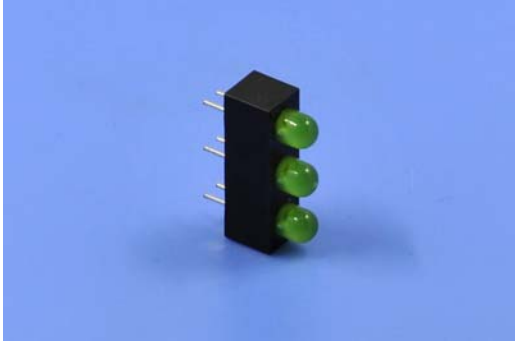

Unit: mm (inch)

Part No.	Emitted Color	λ d (nm)	Lens Appearance	Vf(V) @ I _F =20mA		IV(mcd) @ I _F =20mA	Viewing Angle 2θ 1/2 (deg)
				Typ	Max	Typ	
BL-C35N/3G-32-LC4	Yellow Green	566-576	Color Diffused	2.2	2.6	35	55
BL-C35N/3S-32-LC4	Red	638-648	Color Diffused	2.0	2.6	30	55

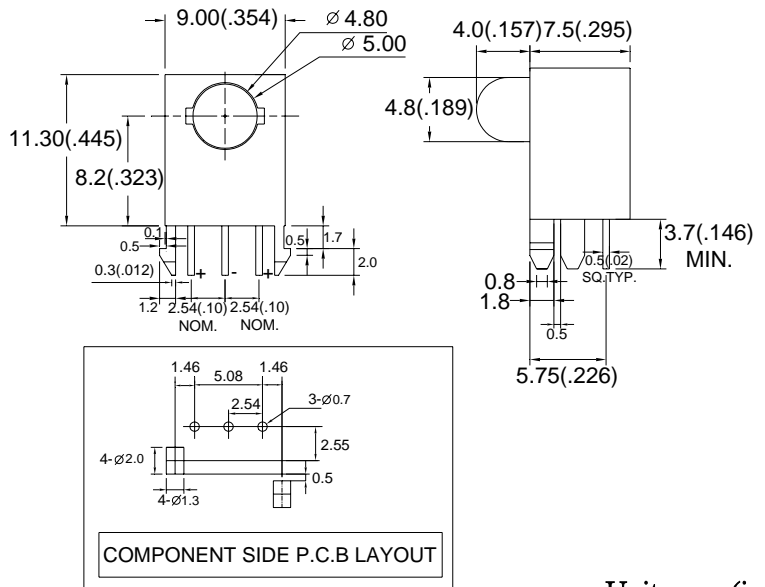
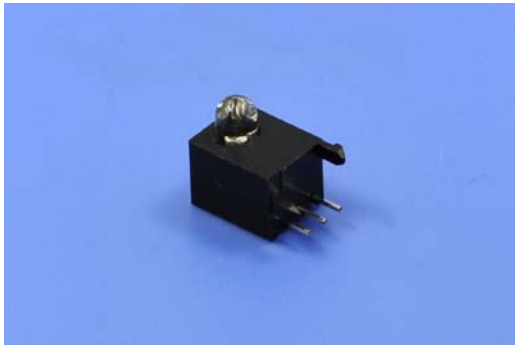

Unit: mm (inch)

Part No.	Emitted Color	λ d (nm)	Lens Appearance	Vf(V) @ I _F =20mA		IV(mcd) @ I _F =20mA	Viewing Angle 2θ 1/2 (deg)
				Typ	Max	Typ	
BL-C52C/GJJEC-03N	Yellow Green Orange Red	566-576 615-628	Transparent	2.1	2.6	1500	35
				2.0	2.6	1000	

HOLDER ASSEMBLY

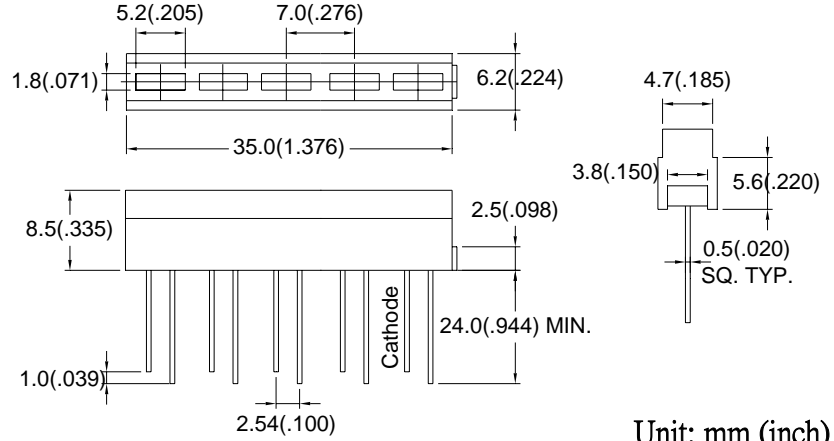

Unit: mm (inch)

Part No.	Emitted Color	λd (nm)	Lens Appearance	Vf(V) @ I _F =20mA		IV(mcd) @ I _F =20mA	Viewing Angle 2θ _{1/2} (deg)
				Typ	Max	Typ	
BL-C55/5G-38-P	Yellow Green	566-576	Color Diffused	2.2	2.6	5	130
BL-C55/4G1H-38	Yellow Green	566-576	Color Diffused	2.2	2.6	5.0	130
	Red	650		2.3	2.6	0.4	

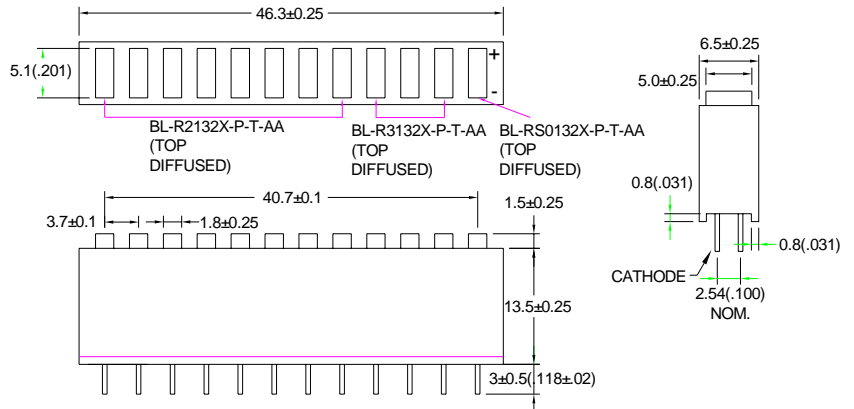
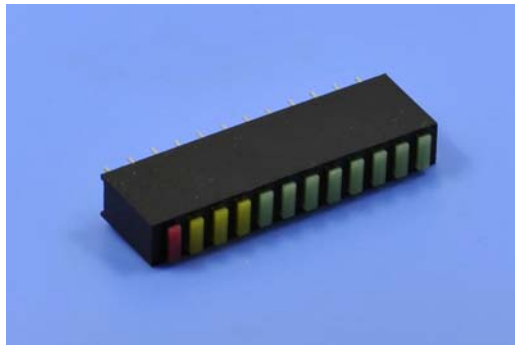

Unit: mm (inch)

Part No.	Emitted Color	λd (nm)	Lens Appearance	Vf(V) @ I _F =20mA		IV(mcd) @ I _F =20mA	Viewing Angle 2θ _{1/2} (deg)
				Typ	Max	Typ	
BL-C22N-B	Yellow Green	566-576	Color Diffused	2.2	2.6	5.0	135
	Yellow	580-594		2.1	2.6	6.0	
	Red	638-648		1.8	2.6	3.0	

HOLDER ASSEMBLY

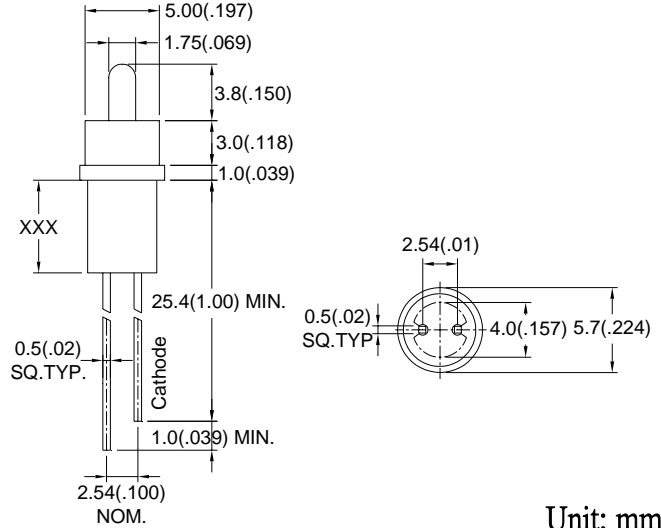

Unit: mm (inch)

Part No.	Emitted Color	λd (nm)	Lens Appearance	Vf(V) @ I _F =20mA		IV(mcd) @ I _F =20mA	Viewing Angle 2 θ 1/2 (deg)
				Typ	Max	Typ	
BL-C38I/G-S31-XXX	Yellow Green	566-576	Color Diffused	2.2	2.6	15	75
BL-C38I/I-S31-XXX	Red	617-638	Color Diffused	2.0	2.6	15	75

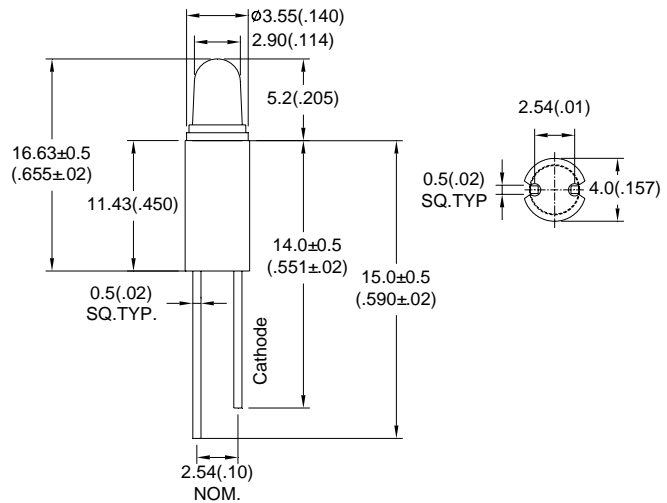

Unit: mm (inch)

Part No.	Emitted Color	λd (nm)	Lens Appearance	Vf(V) @ I _F =20mA		IV(mcd) @ I _F =20mA	Viewing Angle 2 θ 1/2 (deg)
				Typ	Max	Typ	
BL-C38I/I-41T-450-LC14/15	Red	617-638	Color Diffused	2.0	2.6	35	35
BL-C38I/Y-41T-450-LC14/15	Yellow	580-595	Color Diffused	2.1	2.6	30	35